

T. 5N., R. 28E., W. M.

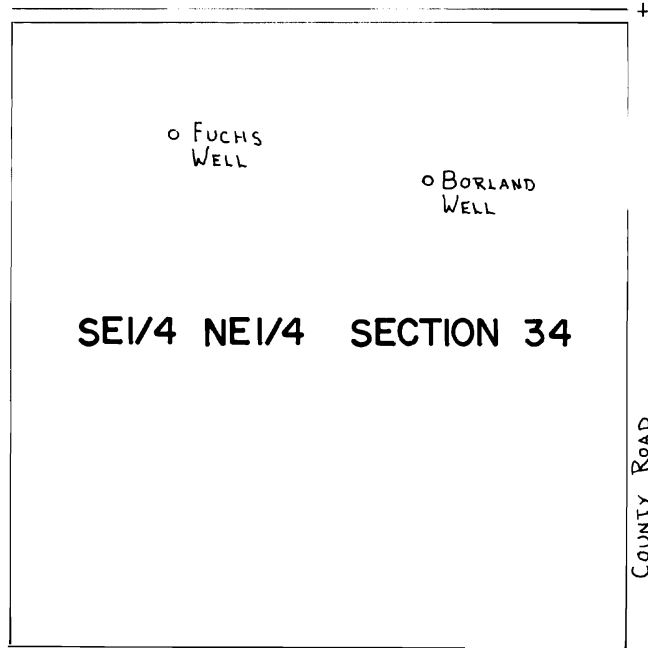

SCALE 1" = 400'



BORLAND WELL LOC: 360' S. & 440' W. *> both from NE Cor. SE 1/4 NE 1/4 Sec. 34*
FUCHS WELL LOC: 260' S. & 980' W.

FINAL PROOF SURVEY
UNDER

TRANSFER 4628

IN NAME OF

A.W. BORLAND, JR. & F. FUCHS

Surveyed *April 3, 1984*, by *V. L. Church*