

REC  
JAN 2 1955

WATER RESOURCES  
SALEM, OREGON

T-4882

2.0 ACRES ON  
4" = 1 MILE APPROX.

MCKENZIE

17 HIGHWAY

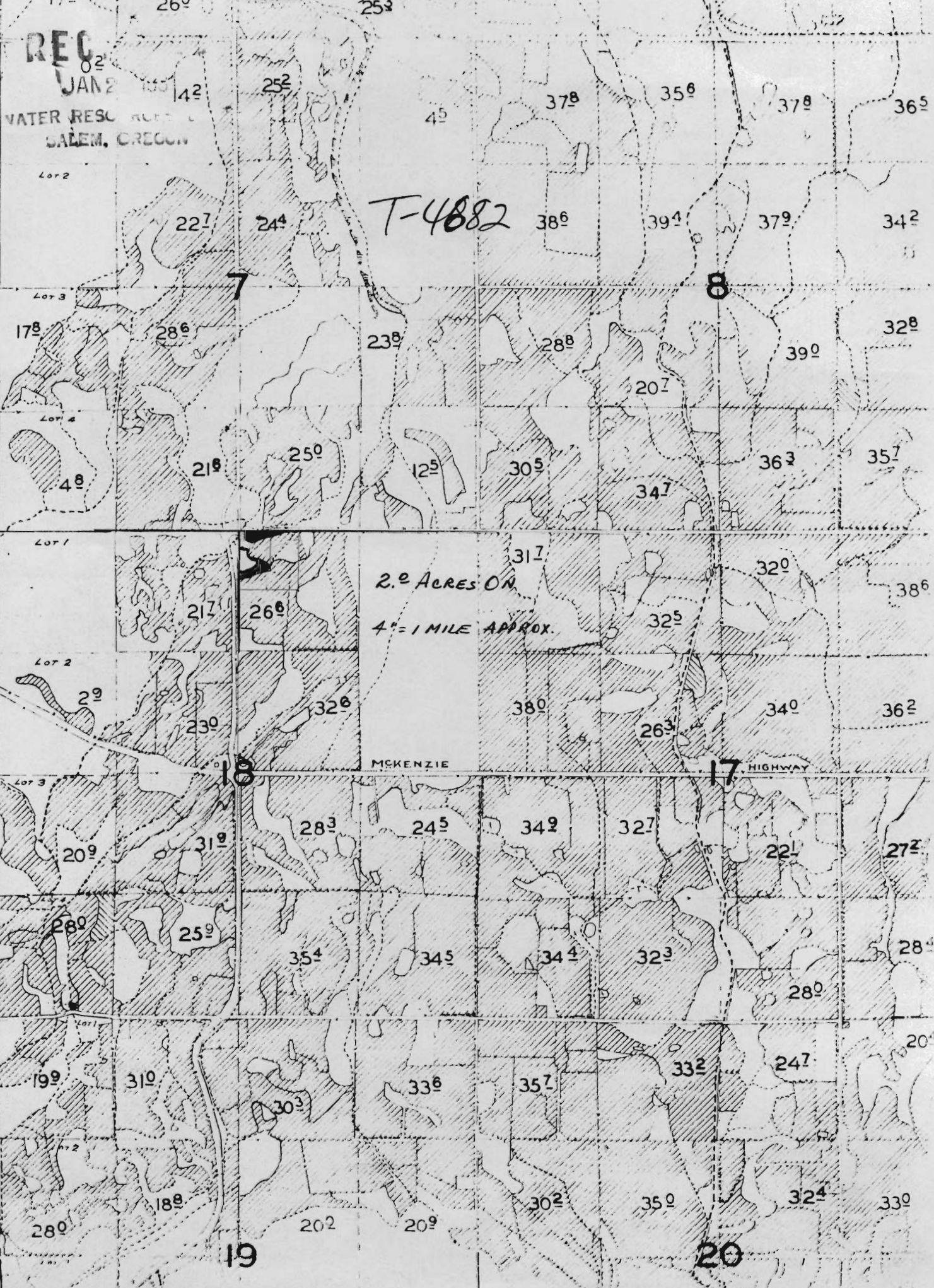

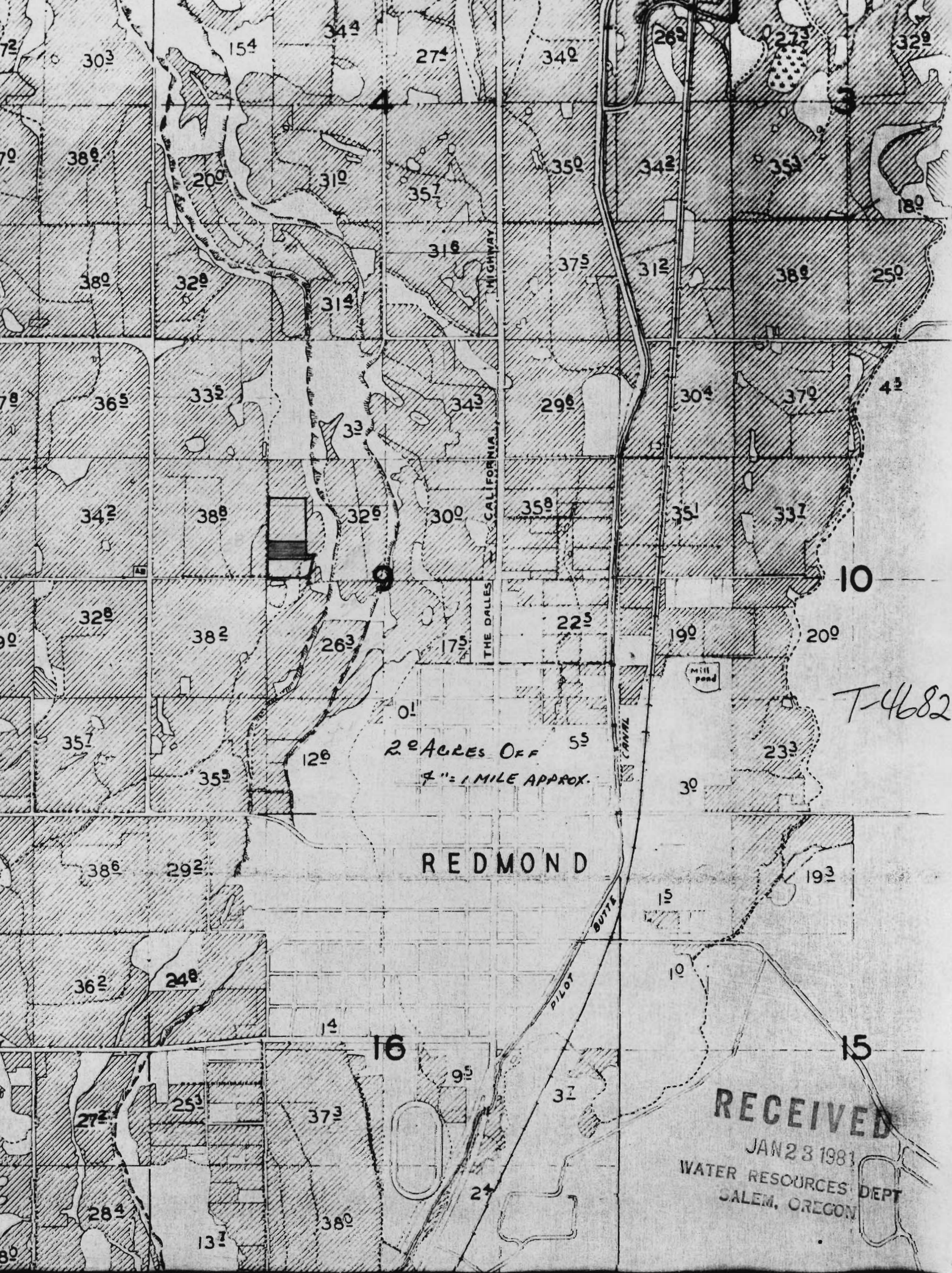

2.0 ACRES OFF  
1/4" = 1 MILE APPROX.

REDMOND

T-4682

RECEIVED  
JAN 23 1981  
WATER RESOURCES DEPT  
SALEM, OREGON