

T.12S.,R.6W.,W.M.

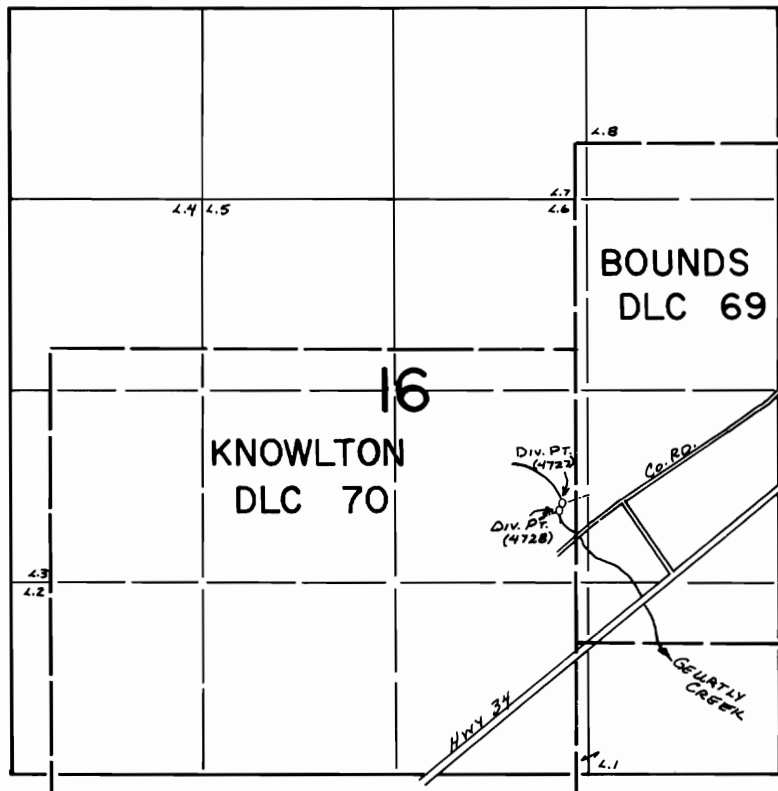

Div. Pt. - (4727) - 770 ft S and 1480 ft W } Both from E 1/4 Cor 56C 16
(4728) - 820 ft S and 1500 ft W }

FINAL PROOF SURVEY
UNDER

Transfer No. 4727 & 4728
Application No. Permit No.
IN NAME OF

.....RAYMOND C. GELLATLY.....

Surveyed Sept. 7... 19.82., by L. M. TOLL.....