

T.12S.,R.6W.,W.M.

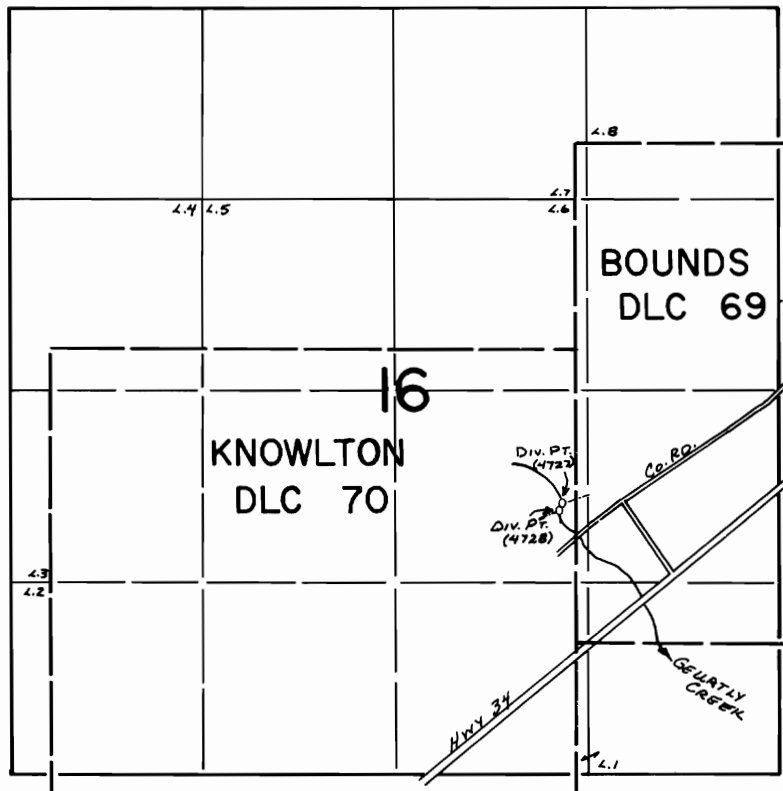

Div. Pt. - (4727) - 770 ft S and 1480 ft W } Both from E 1/4 Cor 56C 16  
(4728) - 820 ft S and 1500 ft W }

**FINAL PROOF SURVEY**  
UNDER

Transfer No. 4727 & 4728  
Application No. .... Permit No. ....  
IN NAME OF

..... **RAYMOND C. GELLATLY** .....

Surveyed Sept. .... 7... 19.82., by L. M. TOLL .....