

T. 2N., R. 30E., W.M.

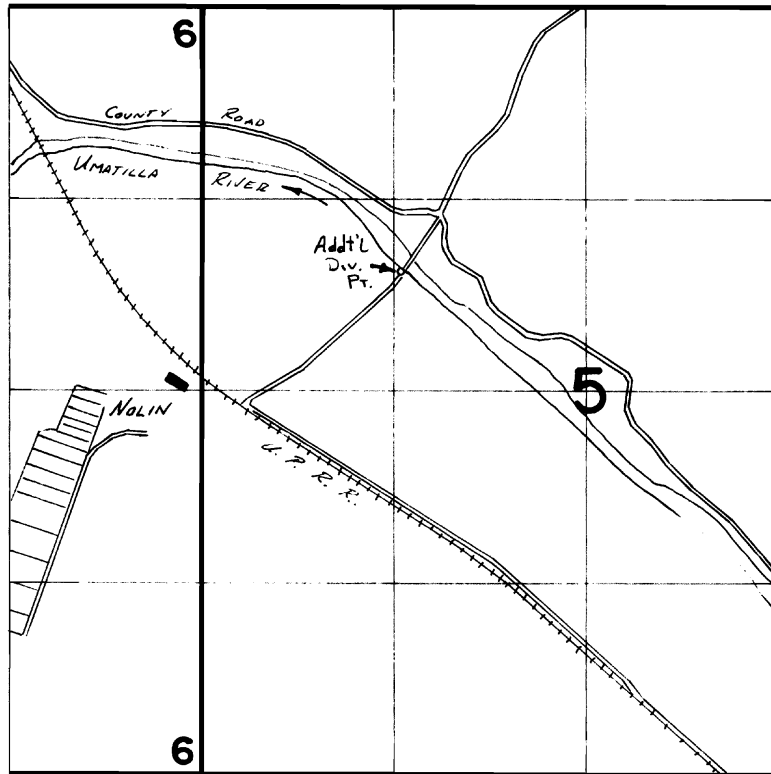

Div. Pt. Loc: 1800' S. & 1360' E NW Cor. Sec 5

FINAL PROOF SURVEY
UNDER

TRANSFER 4763

IN NAME OF

CUMMINGHAM SHEEP CO.

Surveyed ~~for~~ Dec. 22, 1983, by V.L. Church