

Mckenzie Canyon

Deschutes River

Div. Pt.

From
Deep Canyon

OFF MAP

Bob Beesley 40.0 ac.
NE 1/4 Sec. 17
NW 1/4 SW 1/4 Sec. 9
T14S R12E W.M.

Lower Bridge

16

T-4808

From Map

RECEIVED

JUL 1 1981

WATER RESOURCES DEPT.
SALEM, OREGON

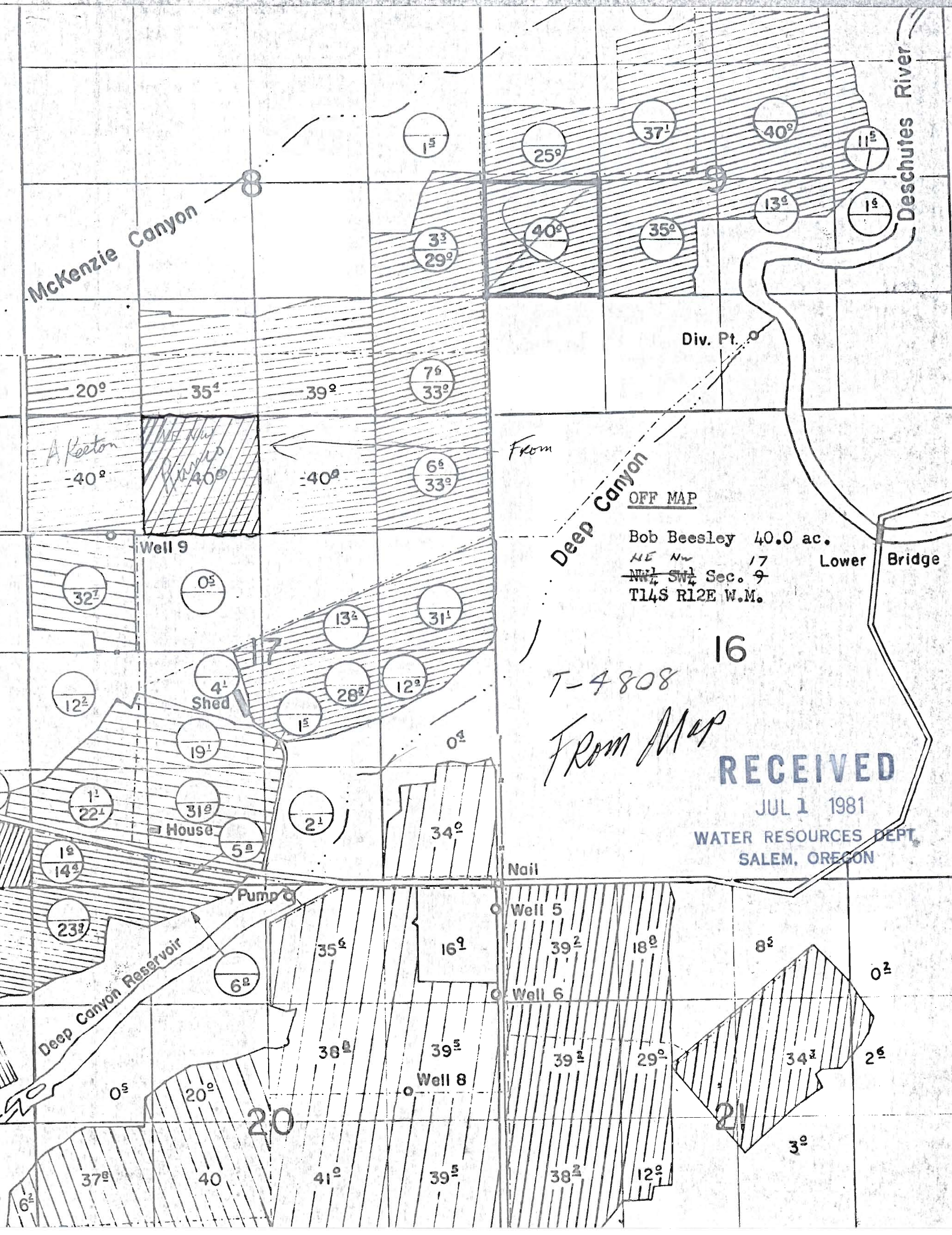

To Map

20

21

22

T-4808

SISTERS

1534

29

28

27

CREEK

30

PLAINVIEW DITCH
DIVERSION POINT

2640'

GAGING STATION

710'

PLAINVIEW DITCH

McALLISTER DITCH

Roy RUNCO

1895 WATER TRANSFER

T155 R10E

4" = 1 MILE

32

WATER RESOURCES DEPT
SALEM, OREGON

JUL 1 1981

RECEIVED

33

