

To Map

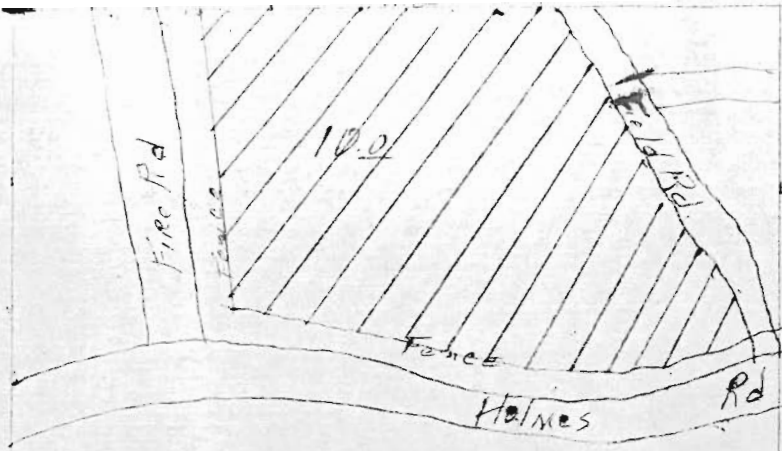

↑
North

4" = 1 mi.
T14S R11E Sec 11

To Harold Duneagan
from R Beesley

NW of NE

NE of NE

T-4889

SW of NE

SE of NW

RECEIVED

SEP 03 1981

WATER RESOURCES DEPT
SALEM, OREGON

From Map

Mckenzie Canyon

Deschutes River



Deep Canyon 10.0 acres
 NE 1/4 Sec 8
 T14S R12E

From B. Beesley
 To Harold Dunigan

T-4884

RECEIVED

SEP 17 1981

WATER RESOURCES DEPT.
 SALEM, OREGON

RECEIVED

SEP 03 1981

WATER RESOURCES DEPT.
 SALEM, OREGON