

T-4890

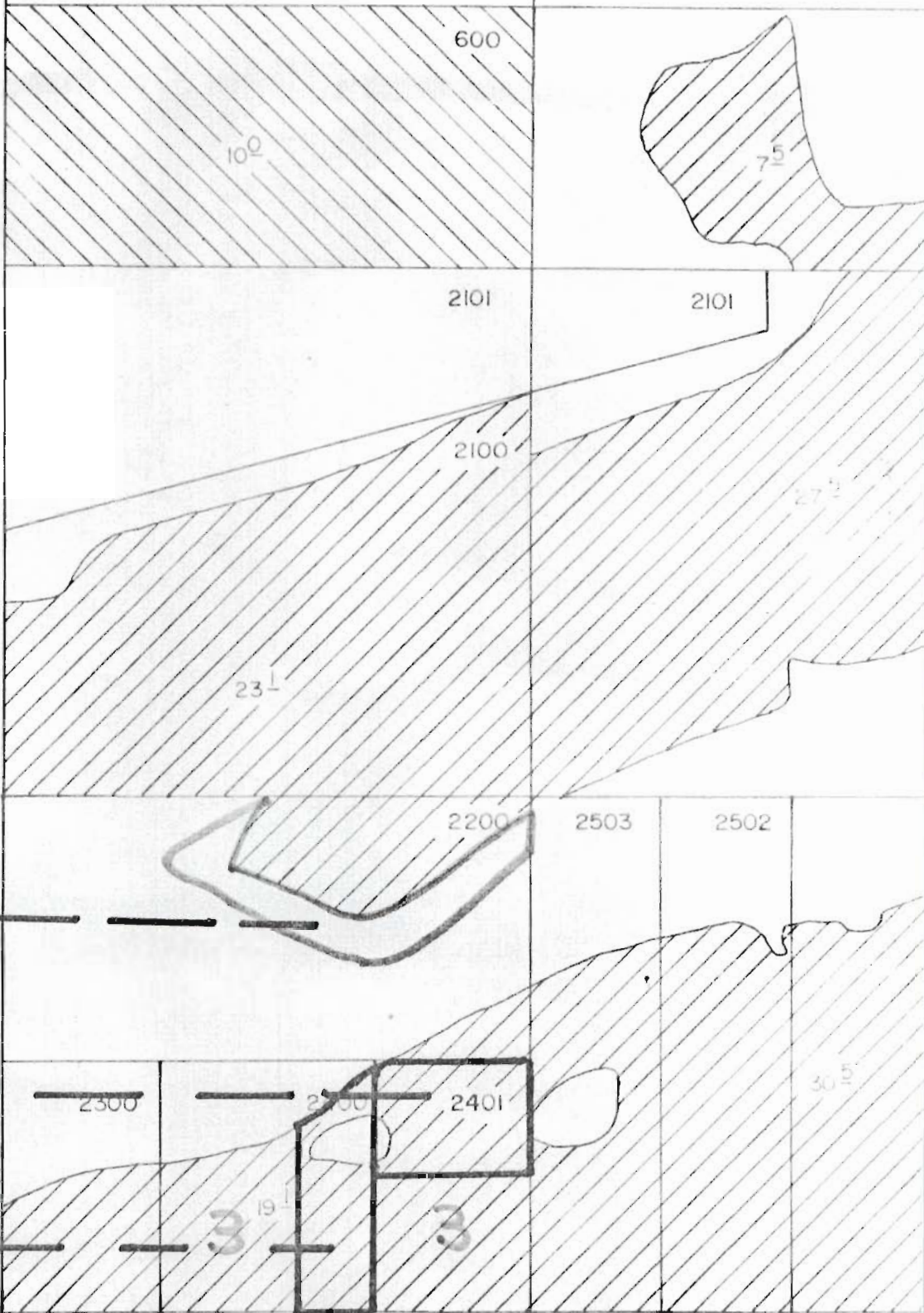

3.0 ON

2.0 OFF

2.0 OFF

RECEIVED

SEP 9 1981

WATER RESOURCES DEPT
SALEM, OREGON



1900



1905

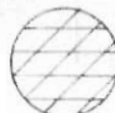

1905



1913

16-11-22

NW 1/4 SEC. 19 T.17 S. R.12 E. W.M.

1" = 200'

T-7890

1.0 ON

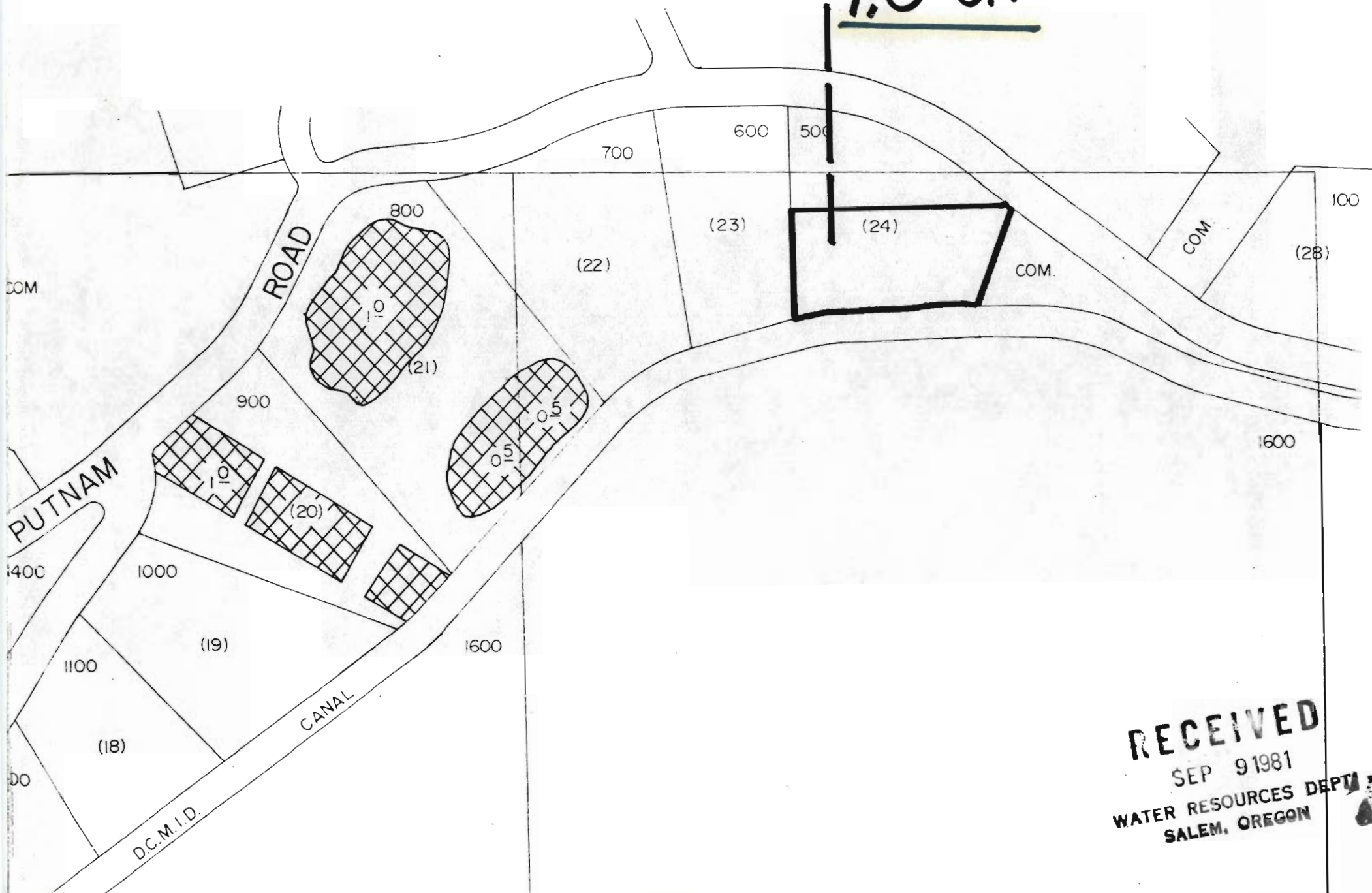

RECEIVED
SEP 9 1981
WATER RESOURCES DEPT
SALEM, OREGON