

T. 13 S., R. 33 E., W.M.

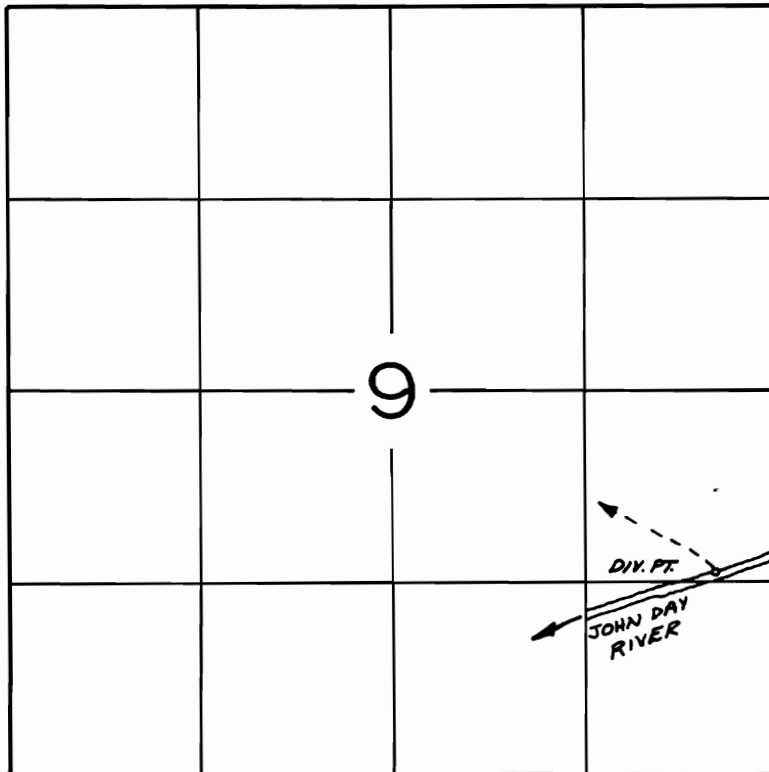

DIV. PT. LOC.: 1390' N & 420' W FROM SE COR. SEC. 9

### FINAL PROOF SURVEY

UNDER

TRANSFER No. 4940

Application No. .... Permit No. ....

IN NAME OF

..... TED BARNHOUSE .....

Surveyed July 19 1983, by R.W. CETTEL