

RECEIVED
DEC 11 1981
WATER RESOURCES DEPT
SALISBURY, OREGON

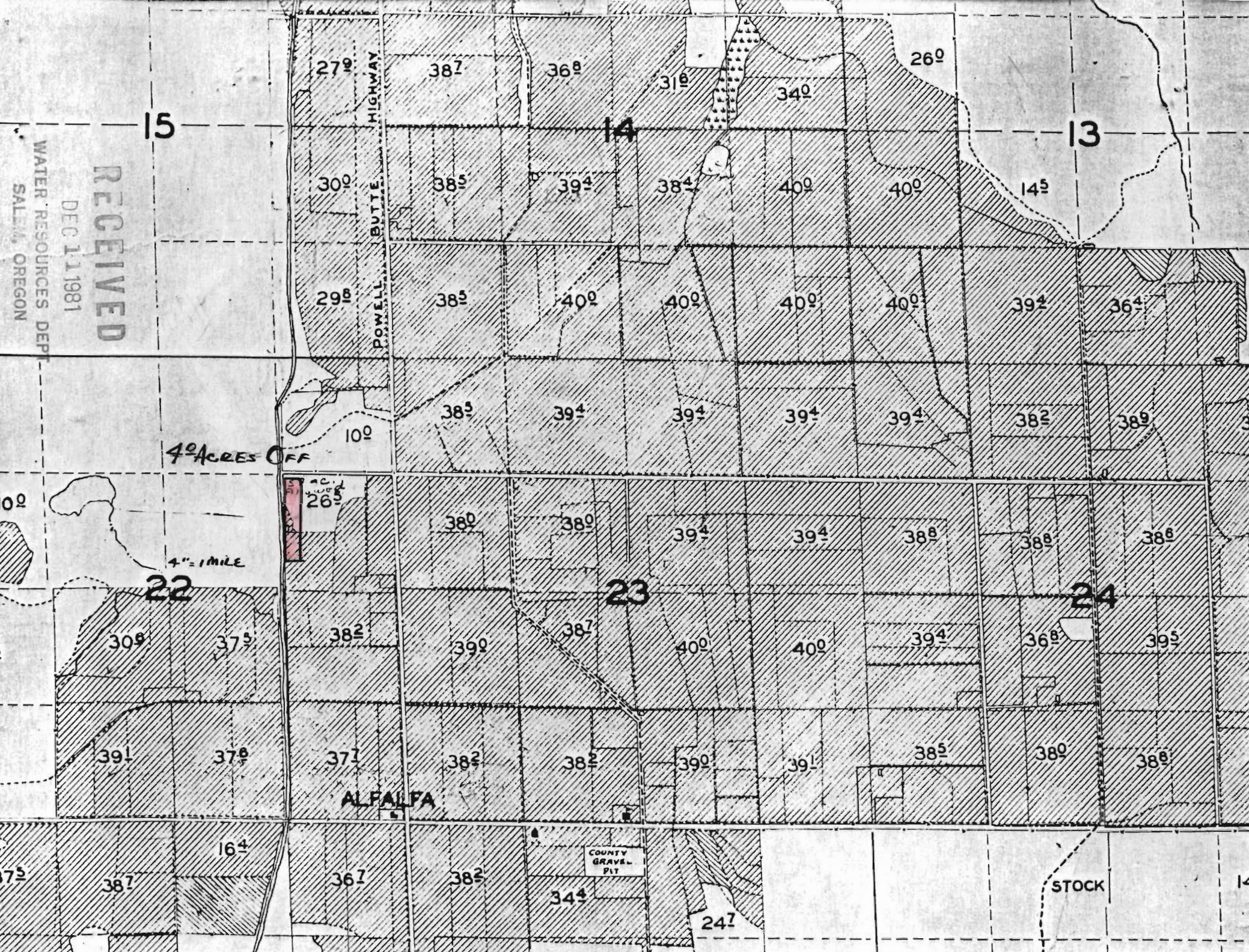



4⁰ Acres ON
4" = 1 MILE APP

T-4952

RECEIVED
DEC 1 1981
WATER RESOURCES DEPT
SAL. M. OREGON

T-4952

RECEIVED

DEC 17 1981

WATER RESOURCES DEPT
SALAS, OREGON

SE 1/4 NE 1/4 SEC. 22 T. 17 R. 14 EWM

RONALD H. MILLER

SCALE: 1" = 200'

