

.6 OFF (c.26050)

1.1 OFF (c.26050)

1.6 OFF (c.26050)

4.8 ON (c.26050)

1.5 OFF (c.26050)

SECTION 6 T.17S. R.12E. W.M.

1" = 400'

T-5021

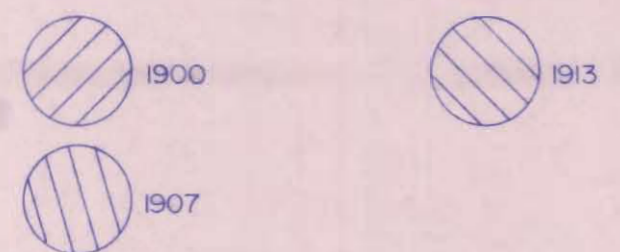
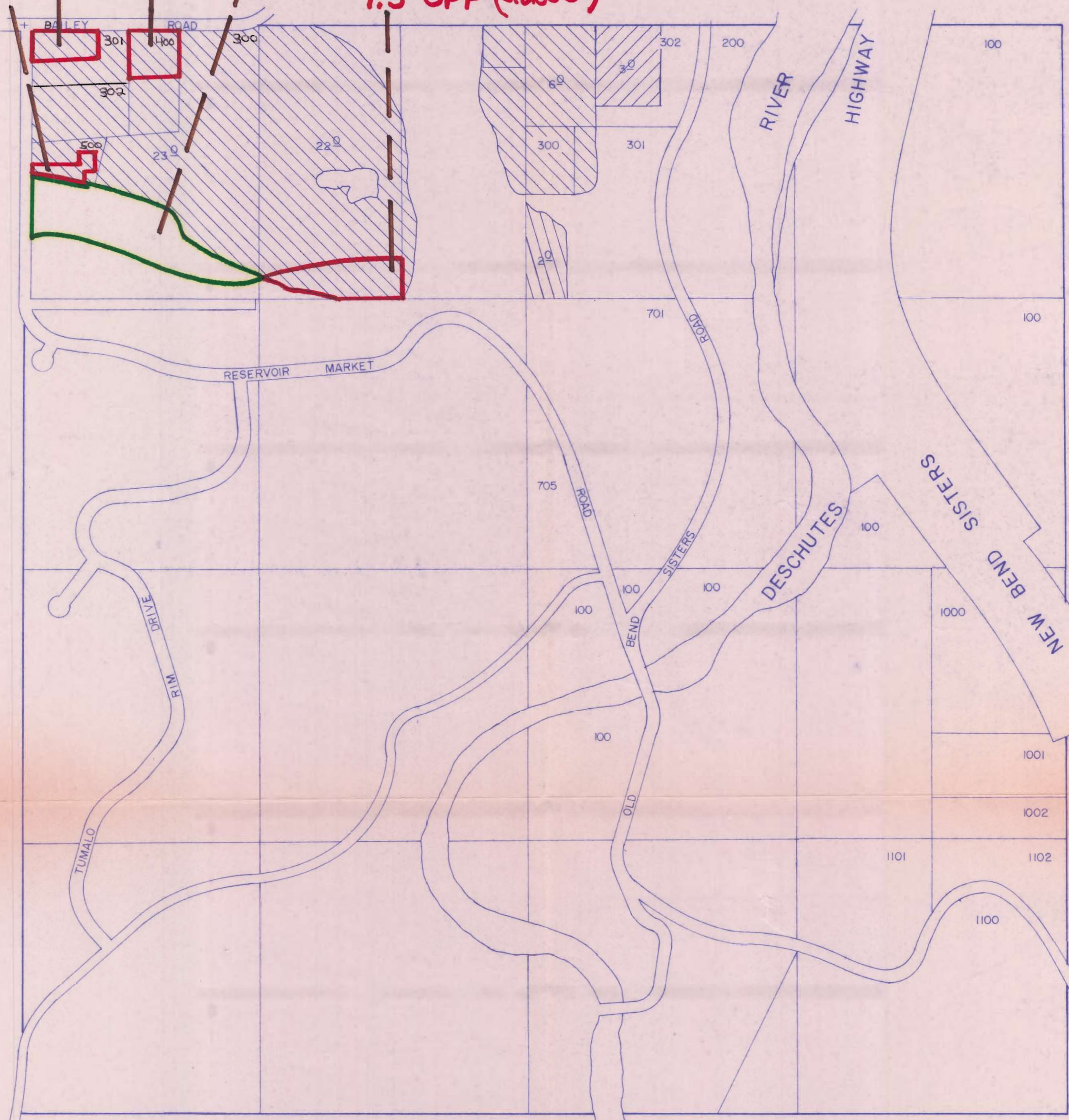

RECEIVED  
 APR 19 1982  
 WATER RESOURCES DEPT  
 SALEM, OREGON