

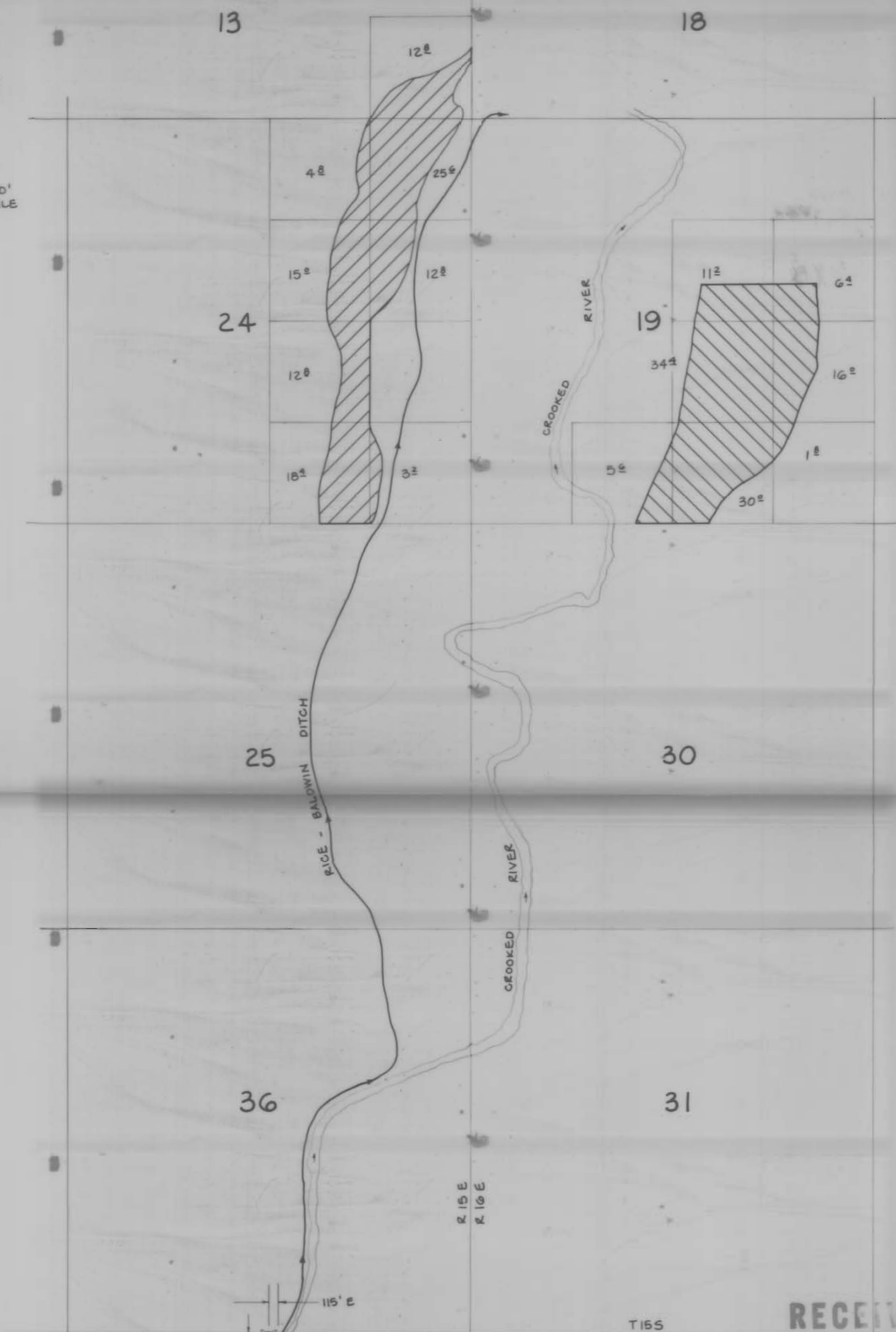

1" = 1320'
4" = 1 MILE





RECEIVED

JUN 2 1982

WATER RESOURCES DEPT
SALEM, OREGON

T155
T165

LEGEND

-  TRANSFER FROM
-  TRANSFER TO

DESIGN BY	CHECKED BY	GLH	WATER RIGHT TRANSFER	APPROVED	CENTURY WEST ENGINEERING CORPORATION
SURVEY BY	SCALE	1" = 1320' 4" = 1 MILE		GLH	
DRAWN BY	DWG. NO.	0001.776. B1	BARTOW - PURCELL - BUCHANAN	DATE	5-14-82