

T. 8S., R. 19E., W. M.

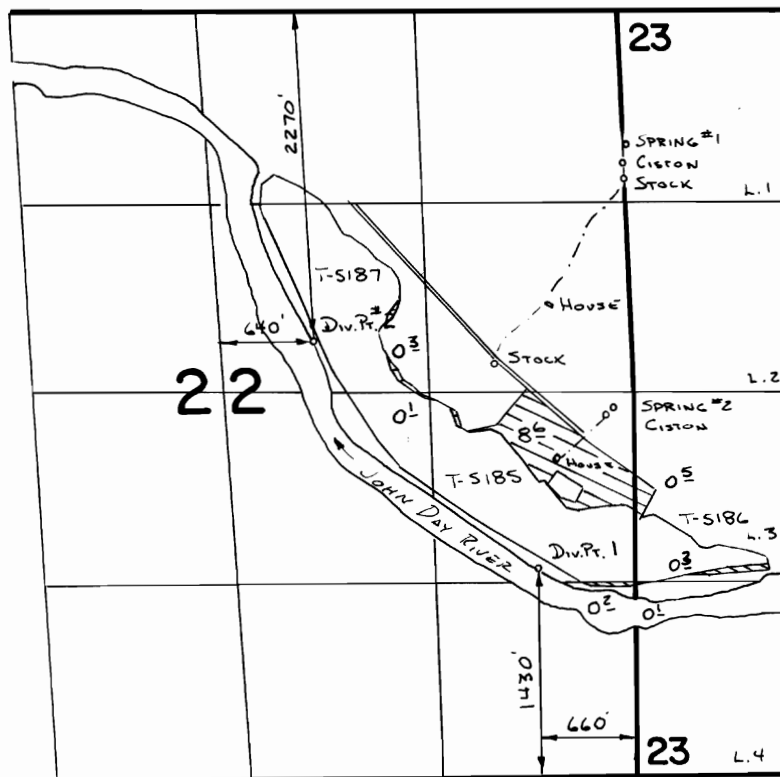

SPRING #1 Loc: 920'S. & 20'E. FROM NW. COR. SEC. 23
 SPRING #2 Loc: 100'S. & 140'W. FROM E 1/4 COR SEC 22

FINAL PROOF SURVEY
 UNDER

TRANSFERS 5185, 5186, 5187
 Application No. **64524** Permit No. **47231**....
 IN NAME OF

.....**JON BOWERMAN**.....

Surveyed ..5..12..... 1987, by *V.L. Church*.....