

T-5219

RECEIVED

MAR 16 1983

WATER RESOURCES DEPT.
SALEM, OREGON

T. 35 S. R. 1 W., W.M.

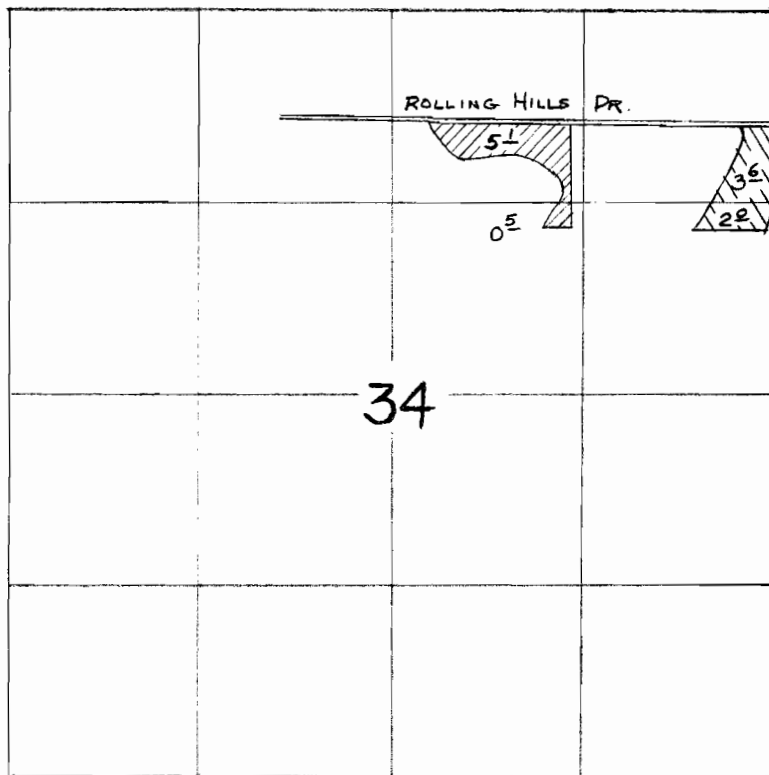

CURRENT PLACE OF USE



PROPOSED PLACE OF USE

DIV. PT LOC. : 1130' SOUTH AND 700' WEST FROM THE NE COR. OF
SEC. 10, T. 35 S., R. 2 E., W.M. BEING WITHIN NE 1/4 OF NE 1/4.

MAP TO ACCOMPANY APPLICATION OF TRANSFER FOR CHANGE IN PLACE
OF USE FOR CHARLES POMEROY