

RECEIVED

MAR 23 1983

WATER RESOURCES DEPT.
SALEM, OREGON

J-5223

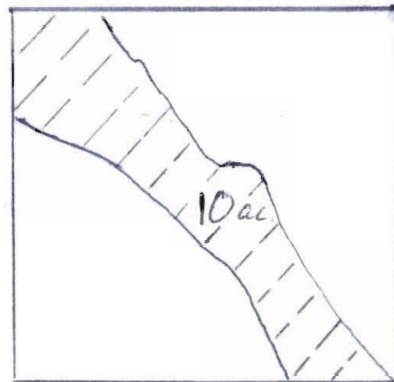

SE $\frac{1}{4}$ SW $\frac{1}{4}$ Sec. 17 T. 7 S., R. 39 E.W.M.

Taken from Aerial Photo Scale 8" = 1 mi.

Jack McGoldwich

FROM

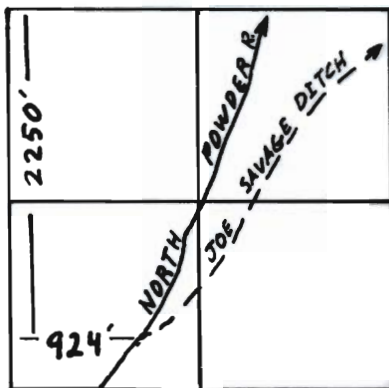

NW $\frac{1}{4}$ Sec. 30

TO

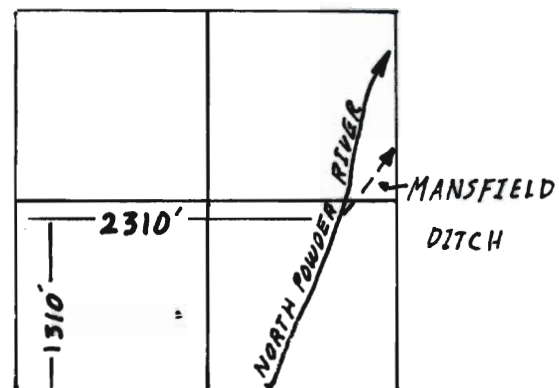

SW $\frac{1}{4}$ Sec. 19

Scale 4" = 1 mile
T. 7 S., R. 38 E.W.M.