

T. 5 N., R. 28 E., W. M.

SW1/4 NW1/4
SECTION 21

FINAL PROOF SURVEY UNDER

TRANSFER 5228
IN NAME OF
LON WADEKAMPER

Surveyed 3-30 1987, by V.L. Church

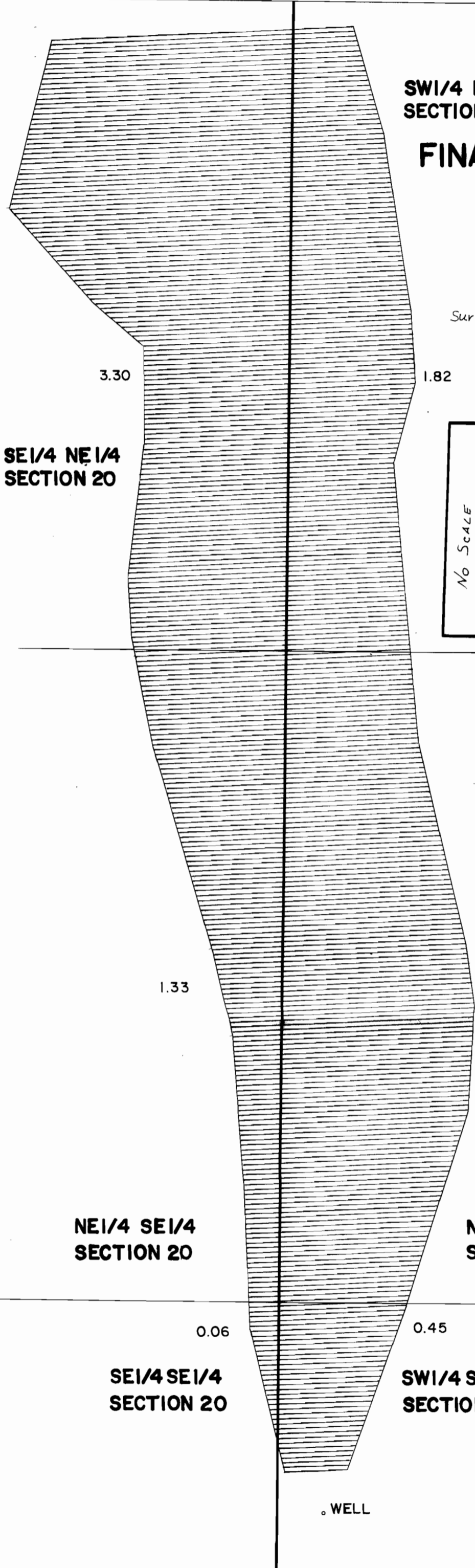

SE1/4 NE1/4
SECTION 20

NE1/4 SE1/4
SECTION 20

SE1/4 SE1/4
SECTION 20

NW1/4 SW1/4
SECTION 21

SW1/4 SW1/4
SECTION 21

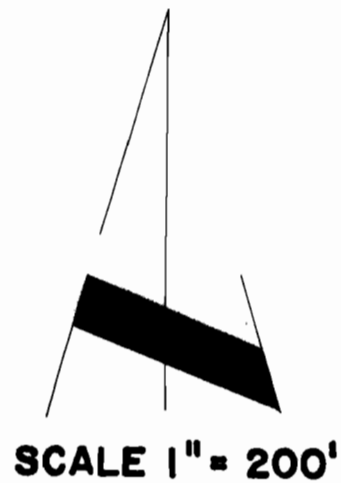
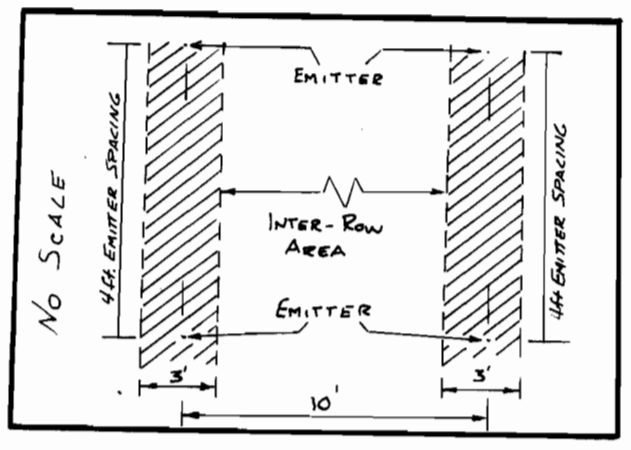

EACH CROSSHATCHED LINE
REPRESENTS ONE ROW OF
GRAPES.

WELL LOCATED: 1750' SOUTH AND
90' EAST FROM WEST 1/4 CORNER
SECTION 21

WELL