

T. 36 S., R. 4 W., W.M.

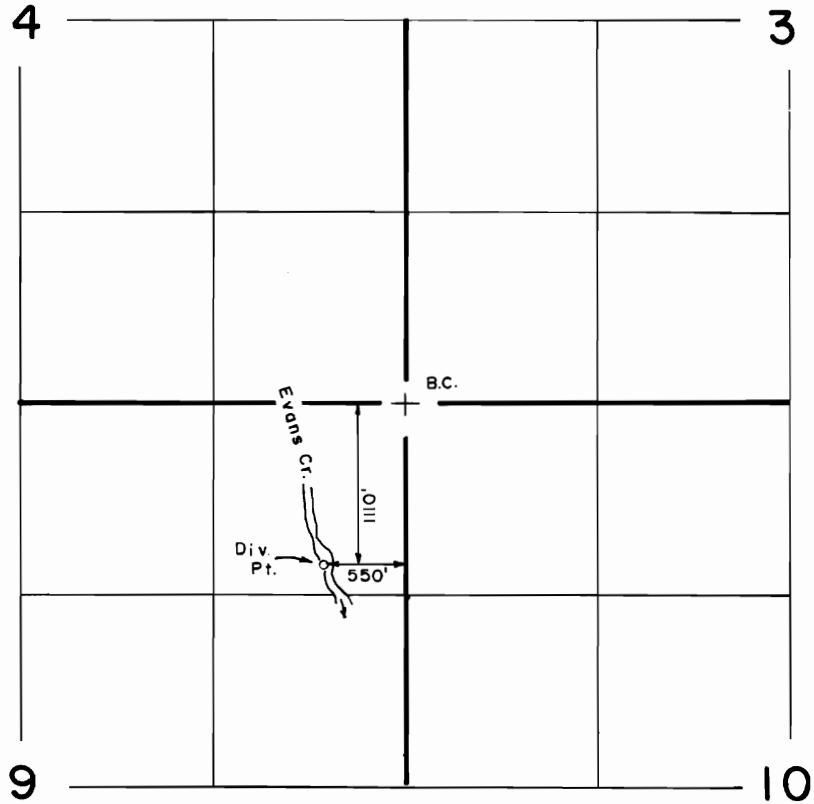

Scale: 1" = 1320'

**FINAL PROOF SURVEY**

UNDER

TRANSFERS NO. 5291 & 5417

Application No. .... Permit No. ....  
IN NAME OF

JOHN & EVA RICHARDS / LAWRENCE & SUE ANN STARR

Surveyed Q.C.T. 13. 1986, by B.S. JAMES.