

# T. 3N., R. 27 & 28E., W.M

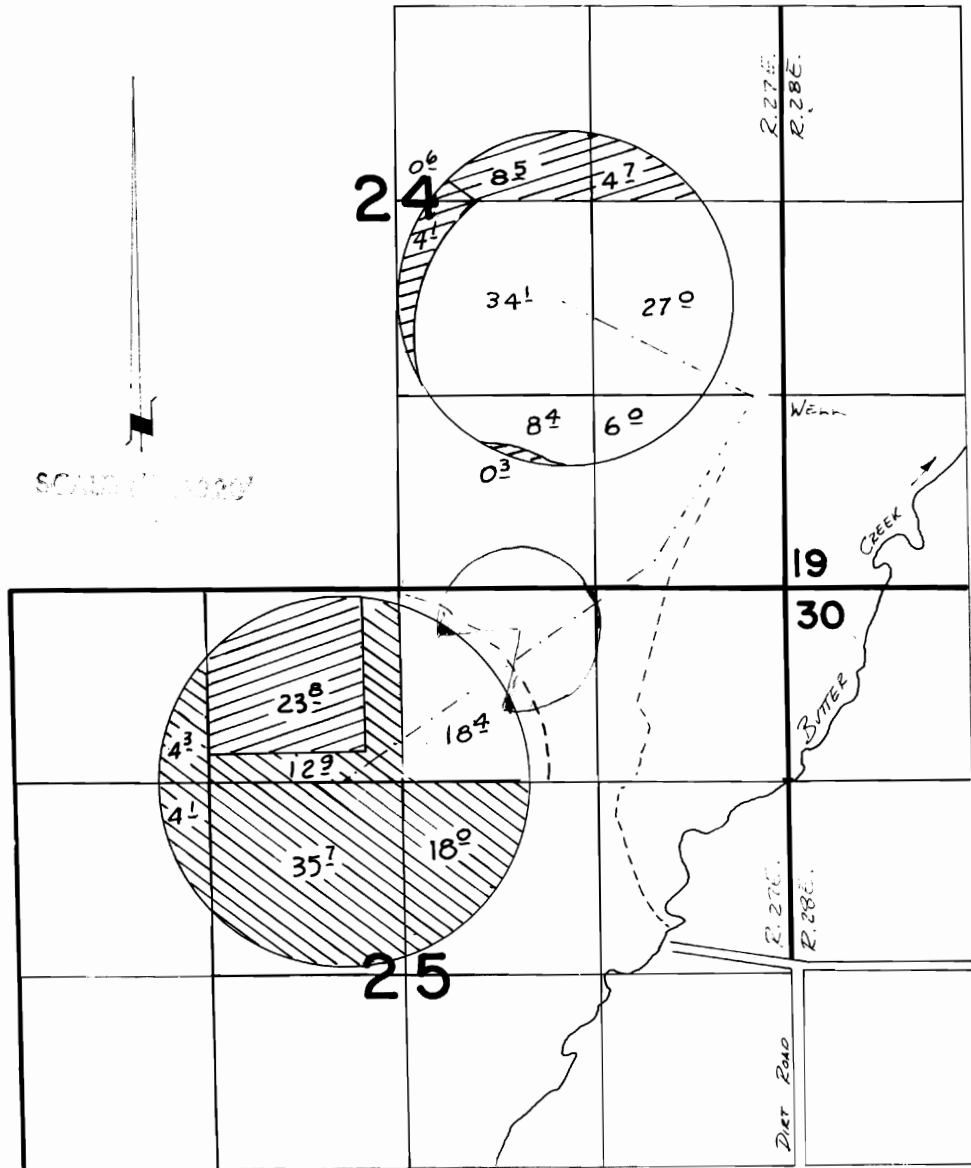

SOILS 10000

WELL LOCATED 1280' N. & 2430' E. FROM S<sup>1</sup>/<sub>4</sub> COR. SECTION 24



Transfer 5432



Per. G-10325

## FINAL PROOF SURVEY

UNDER

**TRANSFER 5432**

Application No. **G-11226** Permit No. **G-10325**

IN NAME OF

.....**JOHN F. MADISON**.....

Surveyed **10-25**..... **1985**., by **V.H. Church**.....