

RECEIVED

APR 28 1984

**WATER RESOURCES DEPT
SALEM, OREGON**

FROM
-34.1-
Deschutes Water Rights
14.0 SWSW 17, 12, 13
0.2 NWSW 17, 12, 13

Deschutes Water Rights
2.0 NESW 17, 12, 13
17.9 SESW 17, 12, 13

T-5474

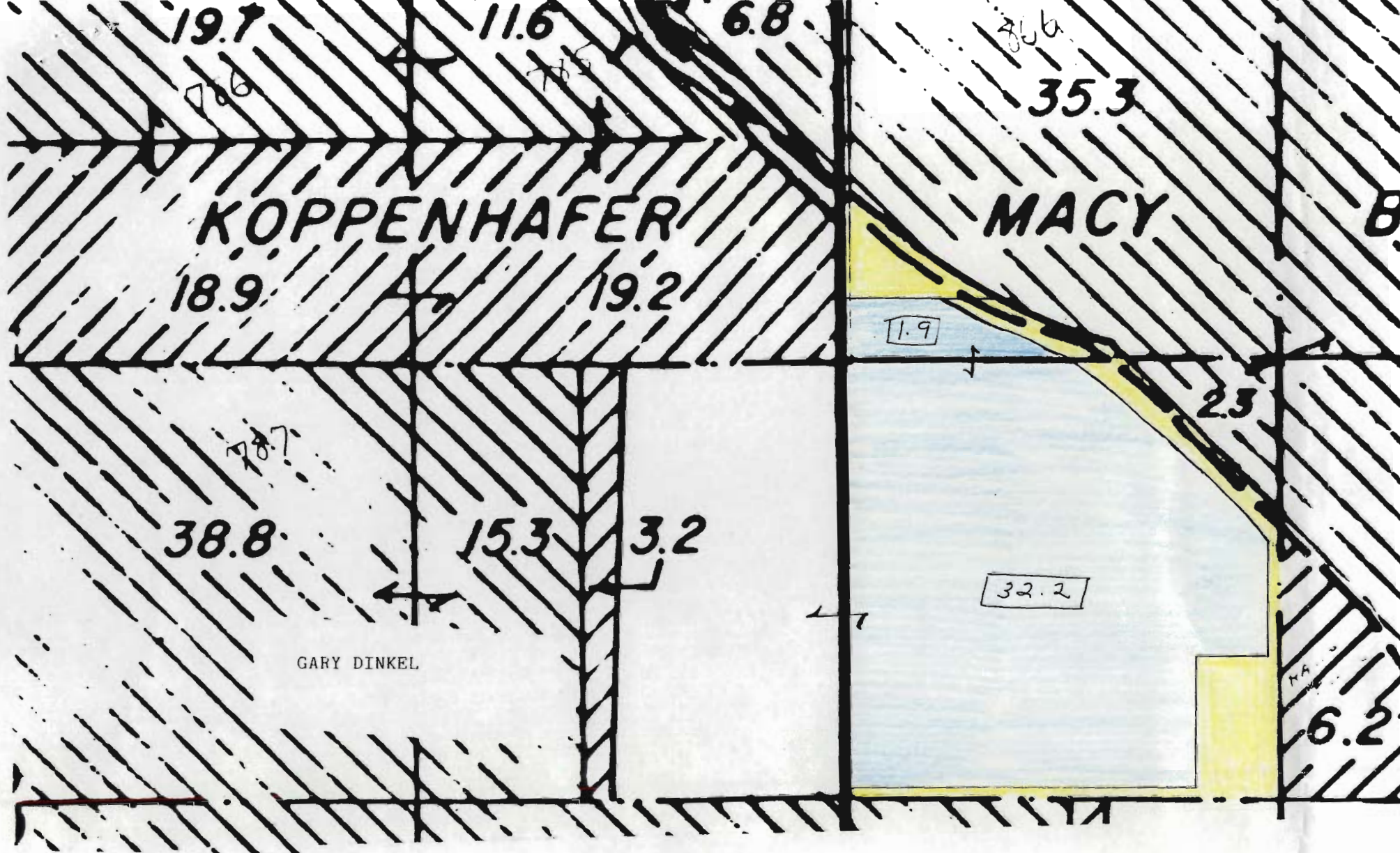

T-5474

TO
 + 34.1 acres of Deschutes Water Rights

Section 9, Township 12, Range 13

1.9 NWNW Pt.

32.2 SWNW