

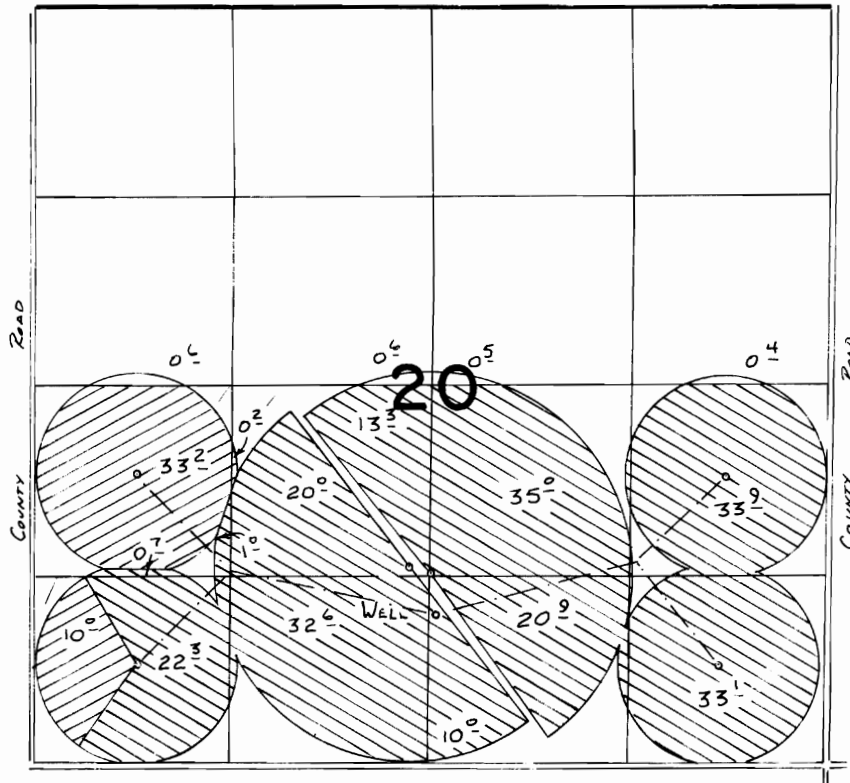

T. 4N., R. 29E., W. M.



WELL LOCATED 1050' N. & 50' E. FROM S 1/4 COR. SECTION 20

-  Per. G-10429
-  T-5501

FINAL PROOF SURVEY
UNDER

APPL. G 11289 PER. G-10429
TRANSFER 5501
IN NAME OF

THE TRAVELERS INSURANCE Co.

Surveyed 10-8 1984, by V. L. Church
3-5 85

SCALE: 1" = 1320'

