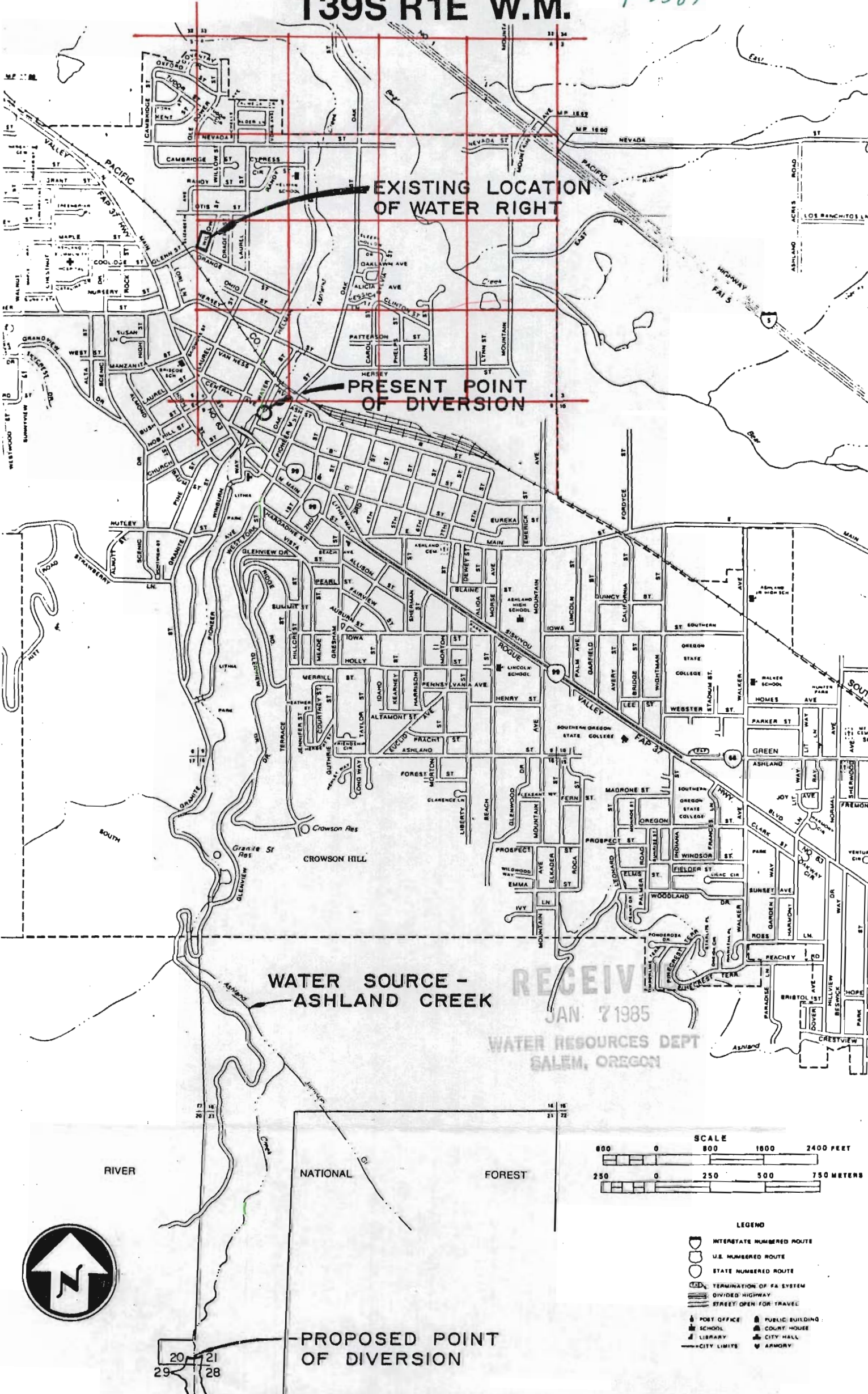

EXHIBIT "D" T39S R1E W.M.

T-5581



EXISTING LOCATION
OF WATER RIGHT

PRESENT POINT
OF DIVERSION

WATER SOURCE -
ASHLAND CREEK

RECEIVED
JAN 7 1985

WATER RESOURCES DEPT
SALEM, OREGON

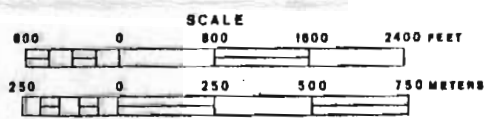

- LEGEND
- INTERSTATE NUMBERED ROUTE
 - U.S. NUMBERED ROUTE
 - STATE NUMBERED ROUTE
 - TERMINATION OF FA SYSTEM
 - DIVIDED HIGHWAY
 - STREET OPEN FOR TRAVEL
 - POST OFFICE
 - SCHOOL
 - LIBRARY HALL
 - CITY LIMITS
 - PUBLIC BUILDING
 - COURT HOUSE
 - CITY HALL
 - ARMORY

PROPOSED POINT
OF DIVERSION

REEDER RESERVOIR