

ON 24 T.17S. R.11E. W.M.

RECEIVED

FEB 27 1985

WATER RESOURCES DEPT
SALEM, OREGON

1" = 400'

2.0 OFF (C. 26508, 8/5/1900)

T-5598

13

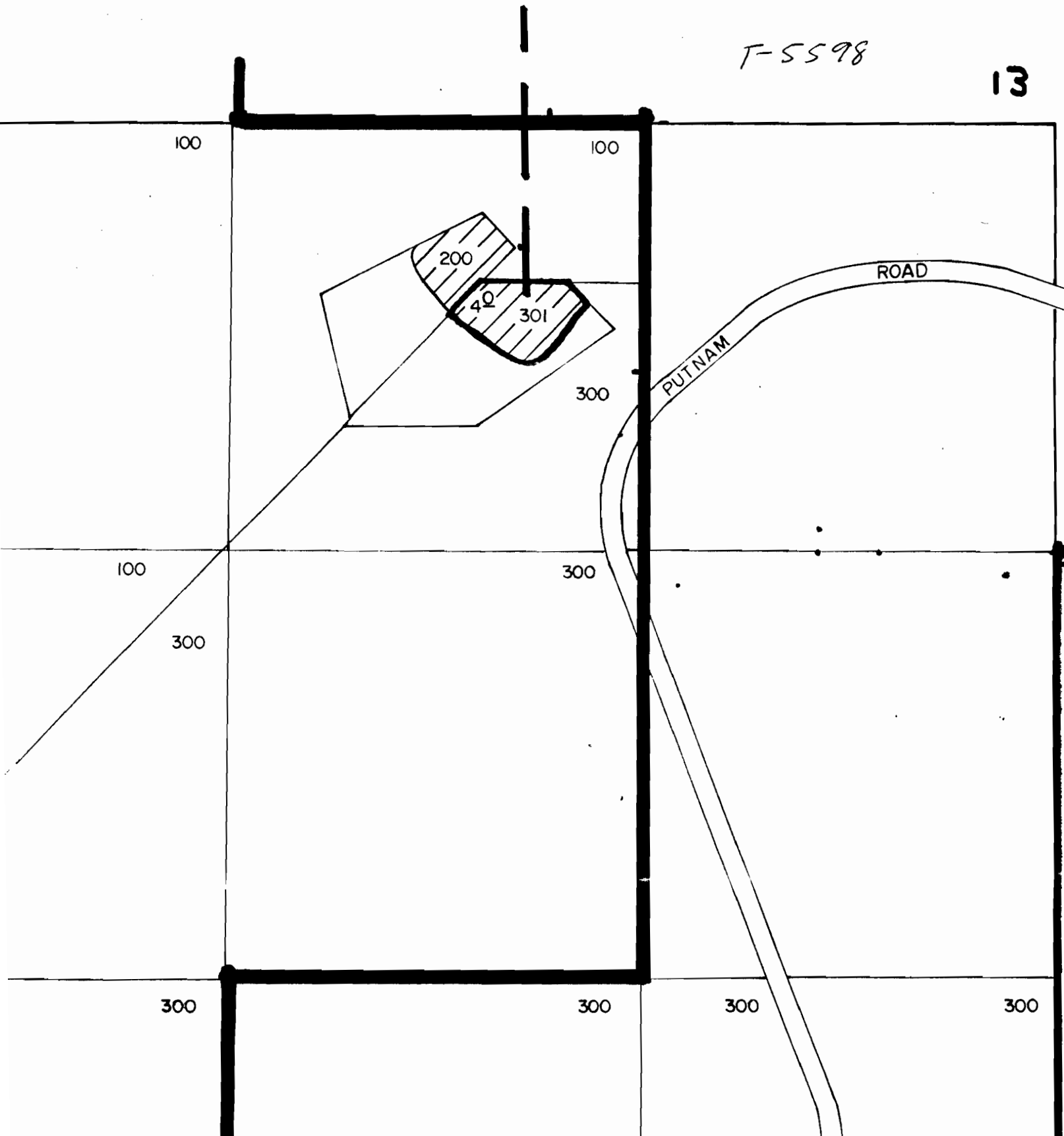

ON 22T.16S. R.11E. W.M.

RECEIVED

FEB 27 1985

WATER RESOURCES DEPT.
SALEM, OREGON

1" = 400'

2.0 ON (C. 26508, 8/5/1900)

T-5598

