

16-11-24

3.0 OFF
L-26508
(6/1/07)

3.0 ON
(6/1/07)
L-26508

RECEIVED
35Q
1985
LAND RESOURCES DEPT
CASSI, 1982

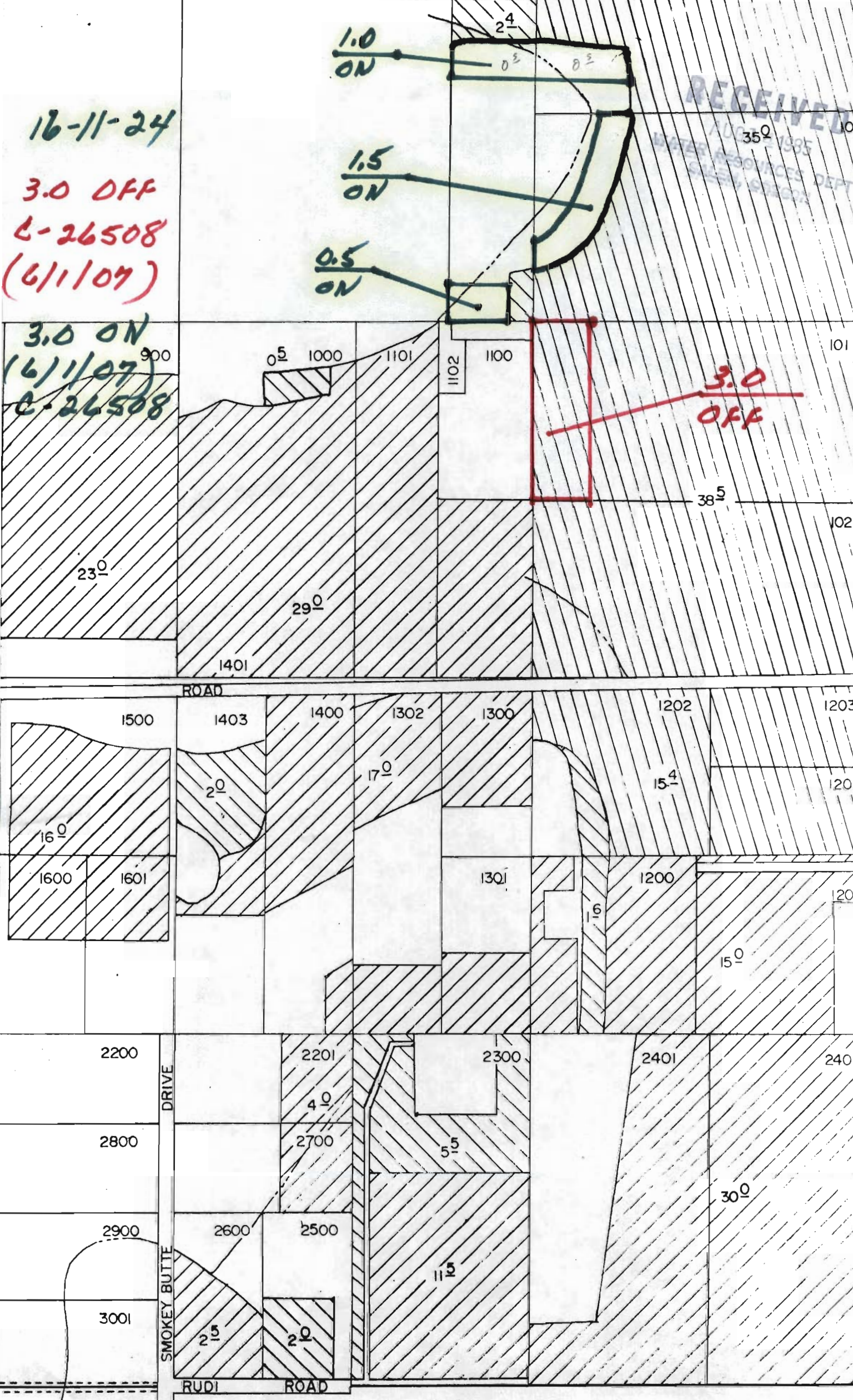

1.0
ON

1.5
ON

0.5
ON

3.0
OFF

ROAD

SMOKEY BUTTE
DRIVE

RUDI ROAD