

RECEIVED

JAN 20 1987

WATER DEPT.
SALEM, OREGON

Amended 11/17

*16-11-23
T.L. 515*

T-5828

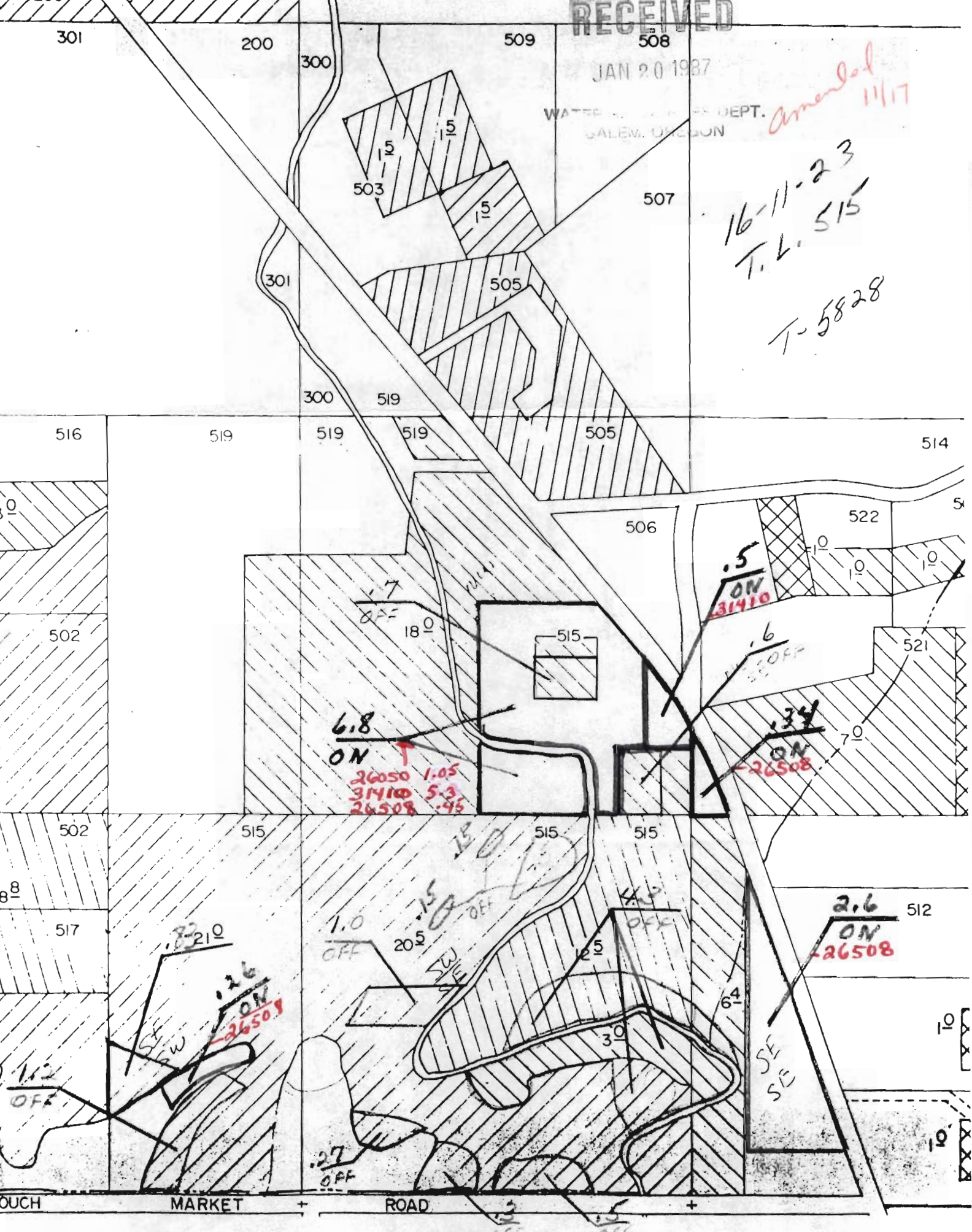

6.8
ON
2650 1.05
31410 5.3
26508 .45

.5
ON
31410

.6
OFF

.34
ON
26508

.82
OFF
26509
2.6
ON
26509

1.0
OFF
205
1.5
OFF

4.2
OFF

2.6
ON
26508

.27
OFF

TOUCH MARKET ROAD