

RECEIVED  
NOV 19 1988  
STATE RESOURCE FILE  
SALEM, OREGON

T.8S., R.40E., W.M.

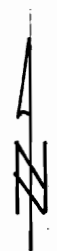
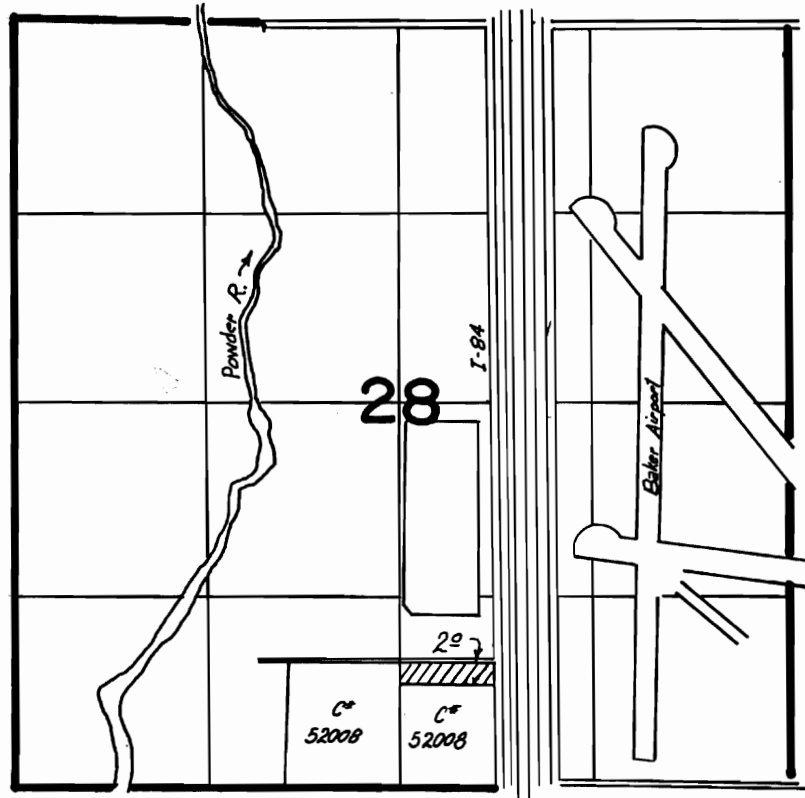

Scale: 1" = 1320'

**FINAL PROOF SURVEY**

UNDER

**TRANSFER 5920**

Application No. .... Permit No. ....

IN NAME OF

.....**ROBERT L. BLACK**.....

Surveyed ...10-2... 1987, by ...Vern Church.....