

T. 4 N., R. 30 E., W. M.

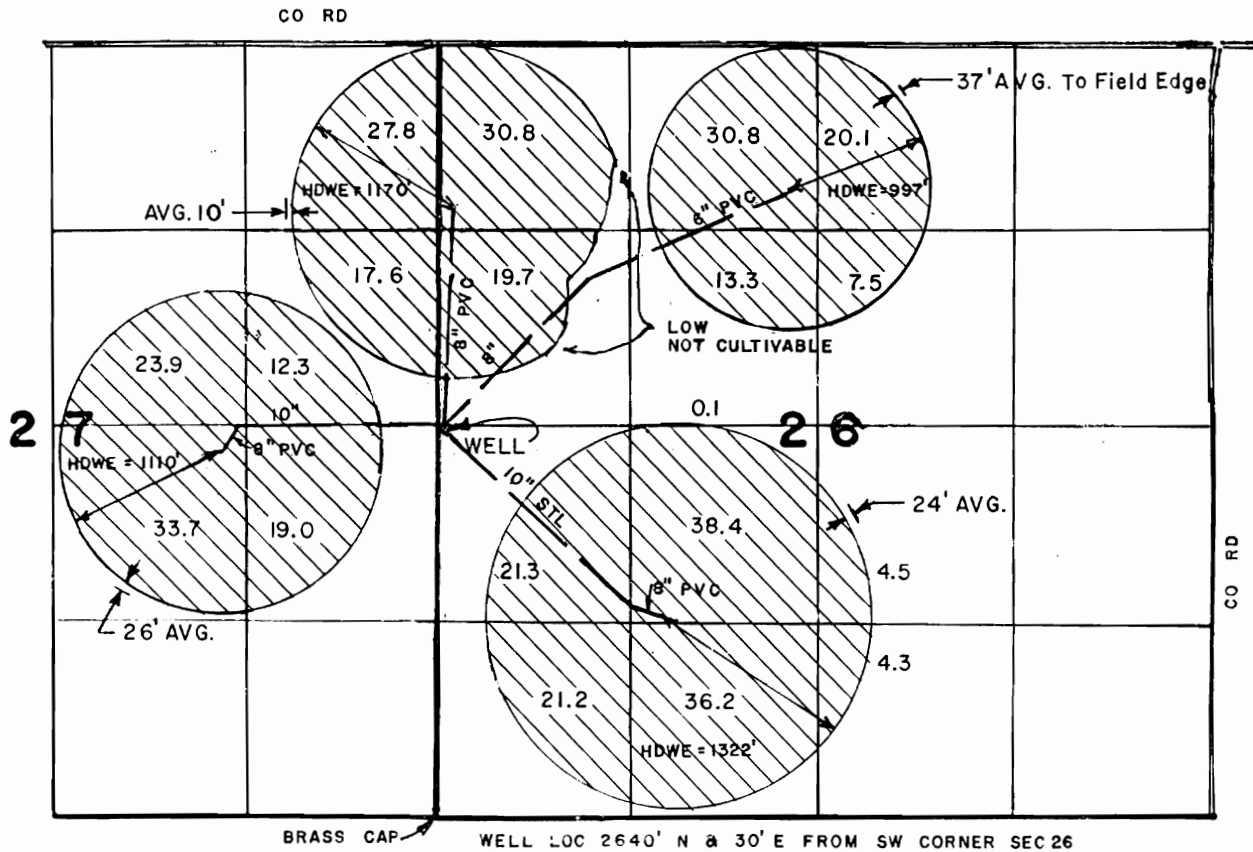

BRASS CAP WELL LOC 2640' N & 30' E FROM SW CORNER SEC 26

SCALE- 1" = 1320'

FINAL PROOF SURVEY UNDER

T-5936
Application No. T-6290 Permit No. G-7965

IN NAME OF
RONALD M. KILGORE

Surveyed... 7/10... 1989, by W. N. REYNOLDS
& 4/9/90

