

# T.8&9S.R.25E.W.M.

**RECEIVED**

JUN 19 1987

WATER RESOURCES DEPT.  
SALEM, OREGON

T-5961

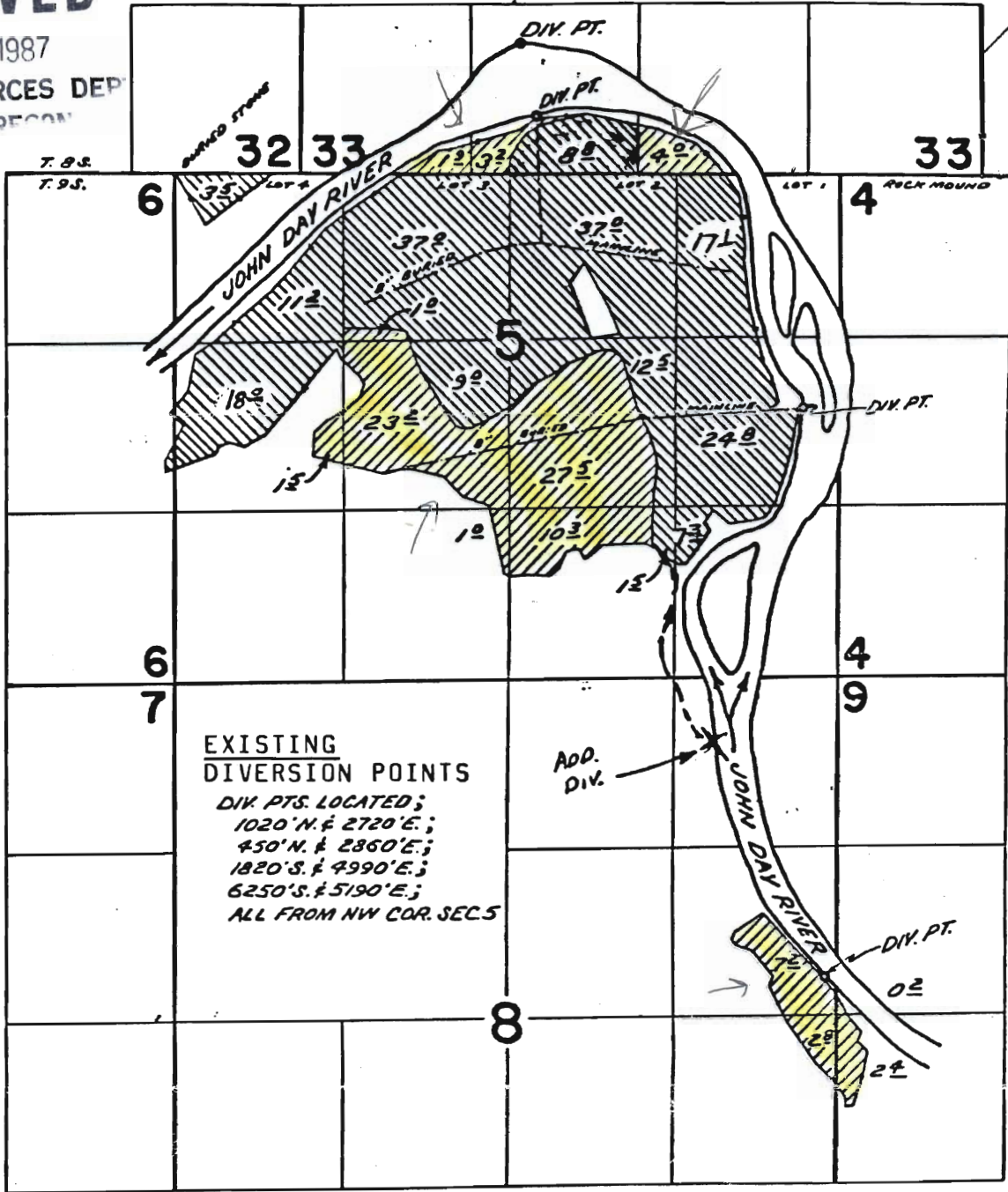

Certificate 52096 & 52098  
 Certificate 36654



4" = 1Mi.

ADDITIONAL DIVERSION POINT LOCATION; 500'S & 1000'W from NE cor. Sec. 8