







T4N, R27E, W.M.
 MORROW COUNTY, OREGON
FINAL PROOF SURVEY

T-6097, T-6098, T-6099, T-6100, T-6101 and T-6102
 IN THE NAME OF
 JEDEDIAH AYLETT
 Rt. 1, Box 1818
 Hermiston, Ore. 97838
 567-5938

-  T-6097
-  T-6098
-  T-6099
-  T-6100
-  T-6101
-  T-6102

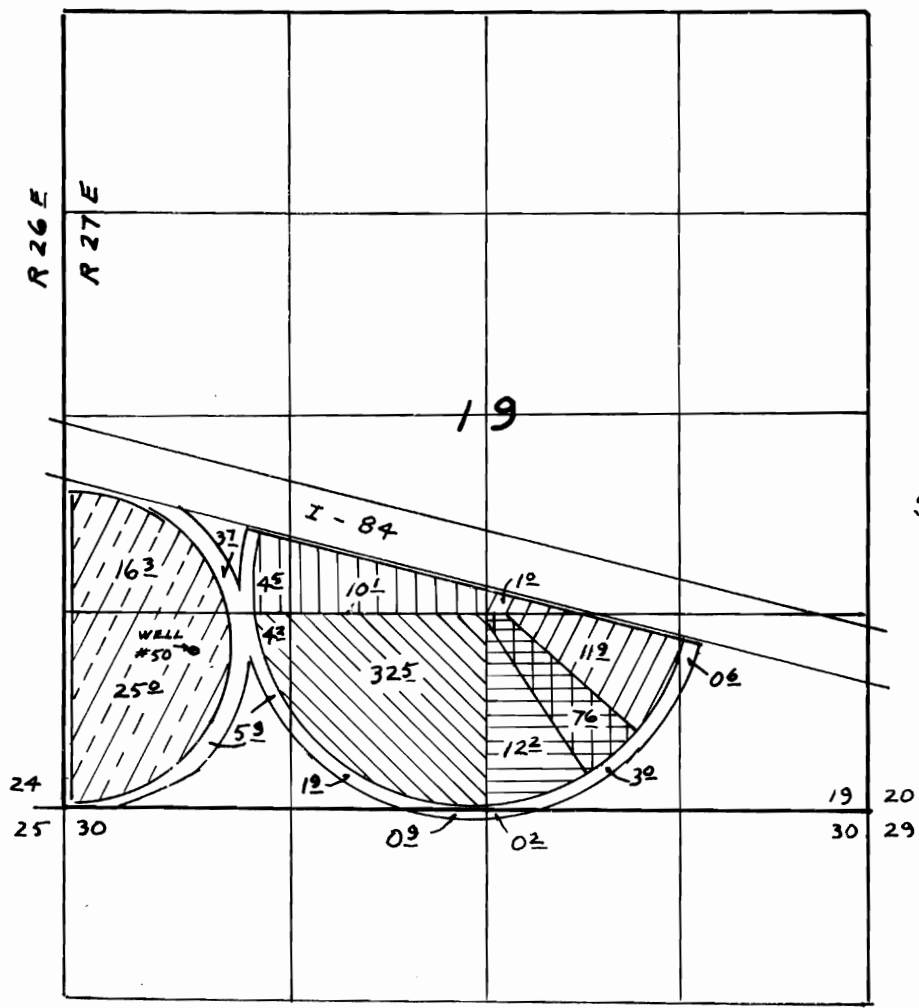

Scale: 1" = 1320'

Well # 50 lies 1077 feet N. and 910 feet E.
 of SW corner of Section 19.

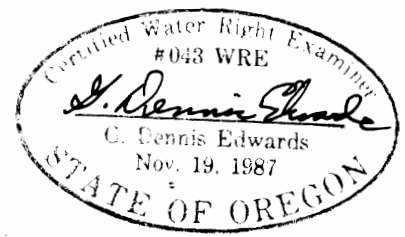

Edwards Surveying P.O. Box 763
 567-3336 Hermiston, OR. 97838
 10/1/91 Job # W8803009-A

This map is for identifying the location
 of water rights only and is not intended
 to show property lines or dimensions.