

T. 16 S., R. 14 E., W.M.

T-6141

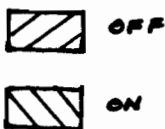

SCALE:  
1" = 1320'

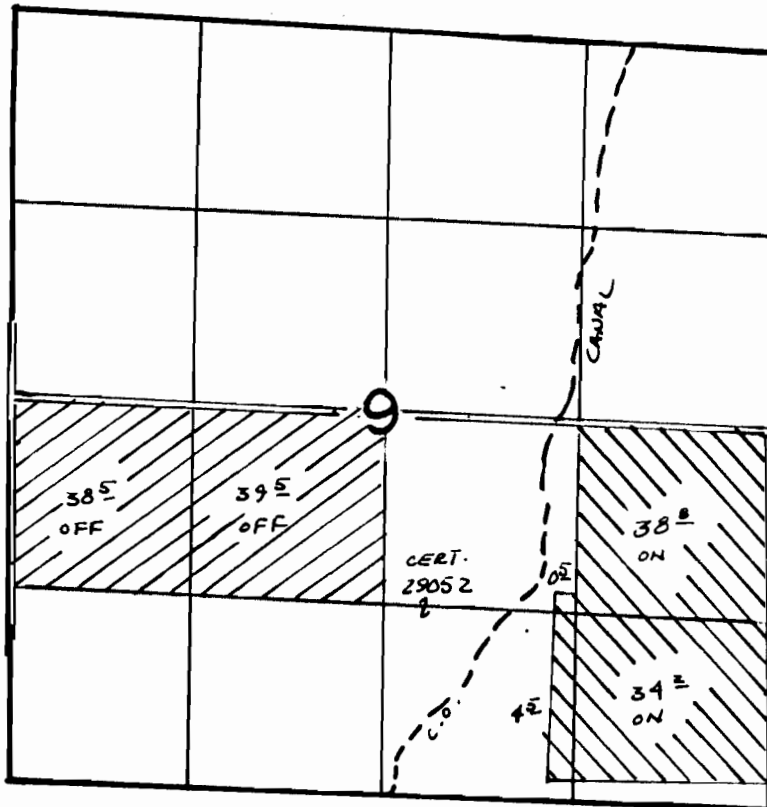

### APPLICATION MAP

for  
U.S. BANCORP

I, James R. Tye, Certified Water Right Examiner in the State of Oregon, hereby certify the above application map was prepared under my direct supervision in cooperation with Central Oregon Irrigation District.

The preparation of this map is for the purpose of identifying the location of the water right only and has no intent to provide dimensions or locations of property ownership lines.

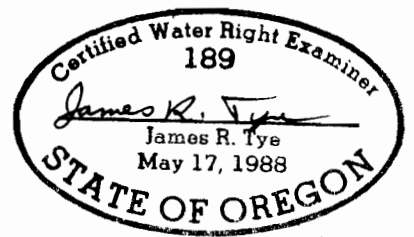

Scale 1" = 1320' | Date 7-26-88 | Survey by B.A. | Drawn by L.D. | Order No. 2286.02

**Sun Country Engineering & Surveying, Inc.**  
61555 SE PARRELL ROAD, BEND, OREGON 382-8882