

RECEIVED

NOV 19 1989

T-13-S, R32-E, W.M.

WATER RESOURCES DEPT.  
SALEM, OREGON

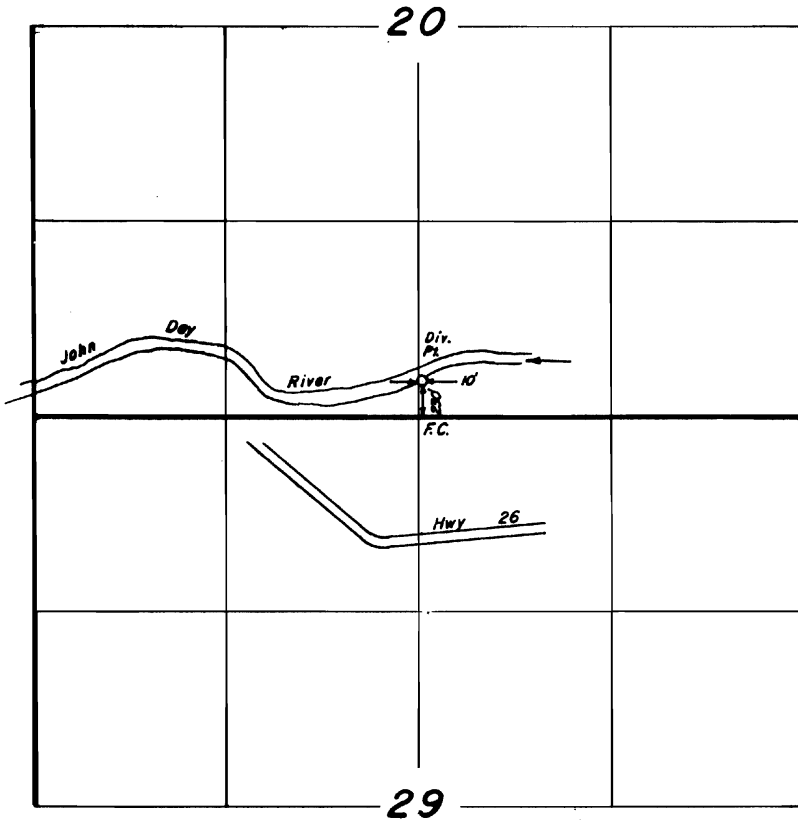

Scale 1"=1320'

**FINAL PROOF SURVEY**

UNDER

Transfer No. 6167

IN NAME OF

NEAL DOW

Surveyed Oct. 3, 1989 By Robert D. Baggett

