

FINAL PROOF SURVEY  
 &  
 CLAIM OF BENEFICIAL USE  
 TRANSFER NO. 6047  
 HAROLD AKES  
 NW 1/4 SW 1/4  
 SEC. 25, T6N, R35E, W.M.

1/4 CORNER  
 S26 © S25

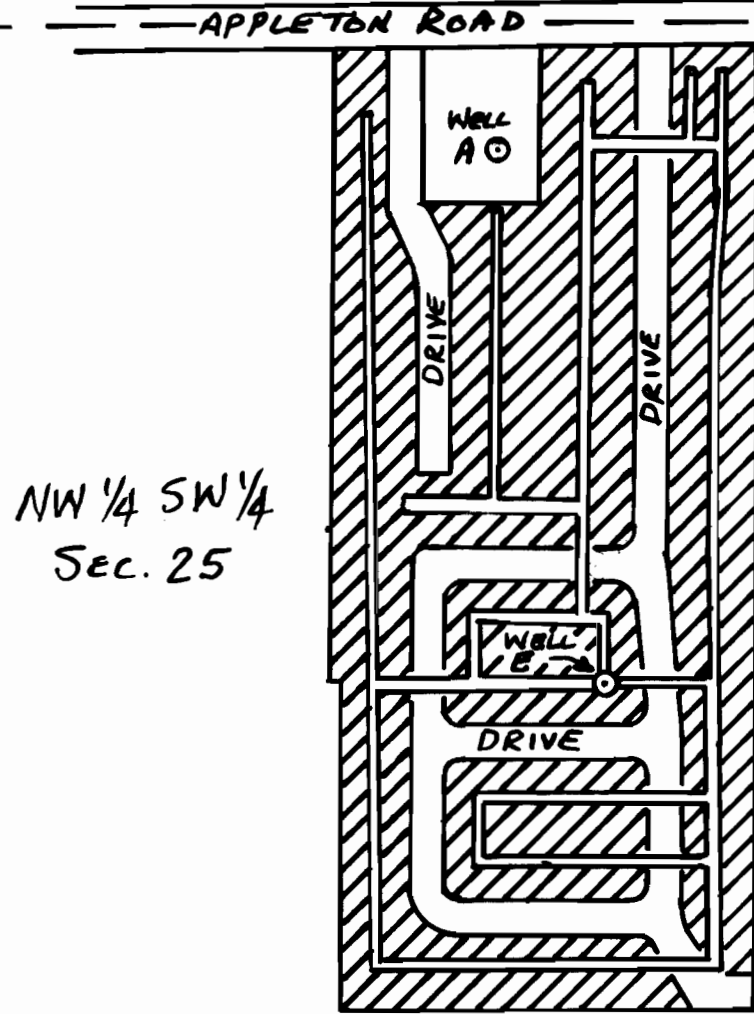

NW 1/4 SW 1/4  
 SEC. 25

STATE HIGHWAY No. 11

NE 1/4 SW 1/4  
 SEC. 25

WELL C

WELL D

WELL "E" IS 654 FT. SOUTH & 921 FT. EAST  
 OF THE 1/4 CORNER S26 / S25.

SW 1/4 SW 1/4  
 SEC. 25

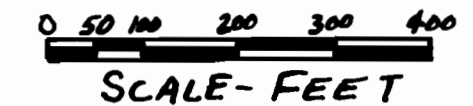
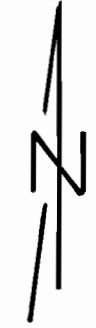

LEGEND

- — — = APPROXIMATE LOCATION OF 1/16<sup>TH</sup> LINES.
- = WELL.
- ==== = APPROXIMATE LOCATION OF WATER LINES (BURIED).
- //// = AREA OF WATER USE FROM WELL "E". DOMESTIC, LAWN & GARDEN USE. GREEN ACRES MOBILE HOME PARK.

THIS MAP IS PREPARED FOR THE EXPRESS  
 PURPOSE TO SHOW WATER APPROPRIATION  
 AND USE. IT IS NOT INTENDED TO SHOW  
 OR LOCATE PROPERTY OWNERSHIP LINES.

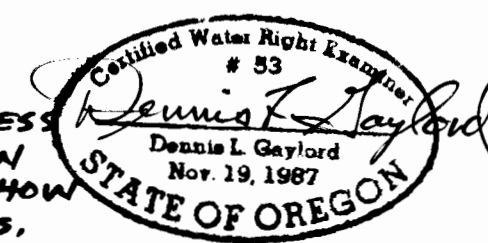

DENNIS L. GAYLORD  
 4107 S.W. LAKE DRIVE  
 PENDLETON, OR 97801  
 503-276-6260