

RECEIVED

APR 05 1988

WATER RESOURCES DEPT.  
SALEM, OREGON

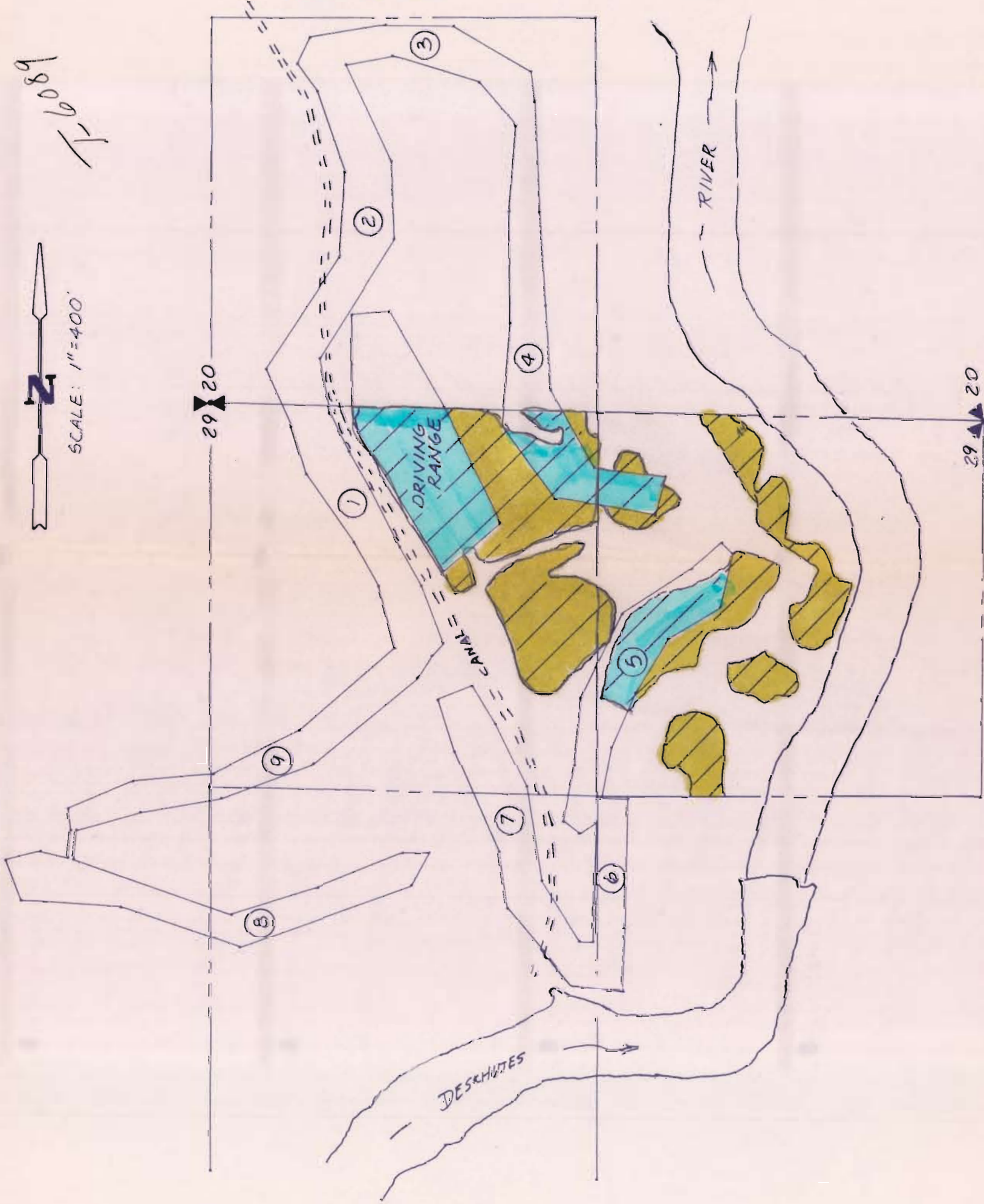
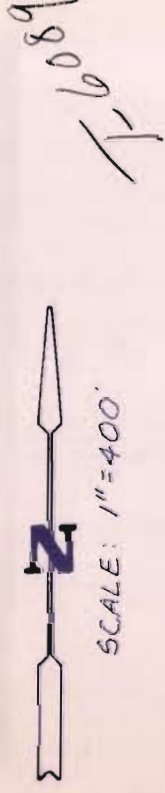

STAY

OUT



IRRIGATED AREA  
PRIOR TO TRANSFER

7 AC. IN NW 1/4 OF NE 1/4  
S. 29

8 AC. IN NE 1/4 OF NE 1/4  
S. 29

OUTLINE OF GOLF COURSE  
SHOWN FOR REFERENCE ONLY.

DUE TO GOLF COURSE CON-  
STRUCTION, THE RIGHT-OF-  
RECORD MAP WAS USED TO  
DETERMINE EXISTING RIGHT.  
(SEE ATTACHED).



29 20  
28 21

REVISIONS	
NO	DATE

DESIGNED BY	DRM	DATE	MAR. 1988
DRAWN BY	SMM	SCALE	1"=400'
CHECKED BY	DRM	SEC	297175 RIZE
DRAWING NO.			10006 002.12

RIVERHOUSE II  
PRIOR TO WATER RIGHTS TRANSFER

FOR: CLYDE PURCELL



SHEET  
1/2