

TOWNSHIP 26 SOUTH, RANGE 4 WEST, W.M.

SECTION 14

RECEIVED

FEB - 2 1993

WATER RESOURCES DEPT.
SALEM, OREGON

RECEIVED

SEP 17 1992

WATER RESOURCES DEPT.
SALEM, OREGON

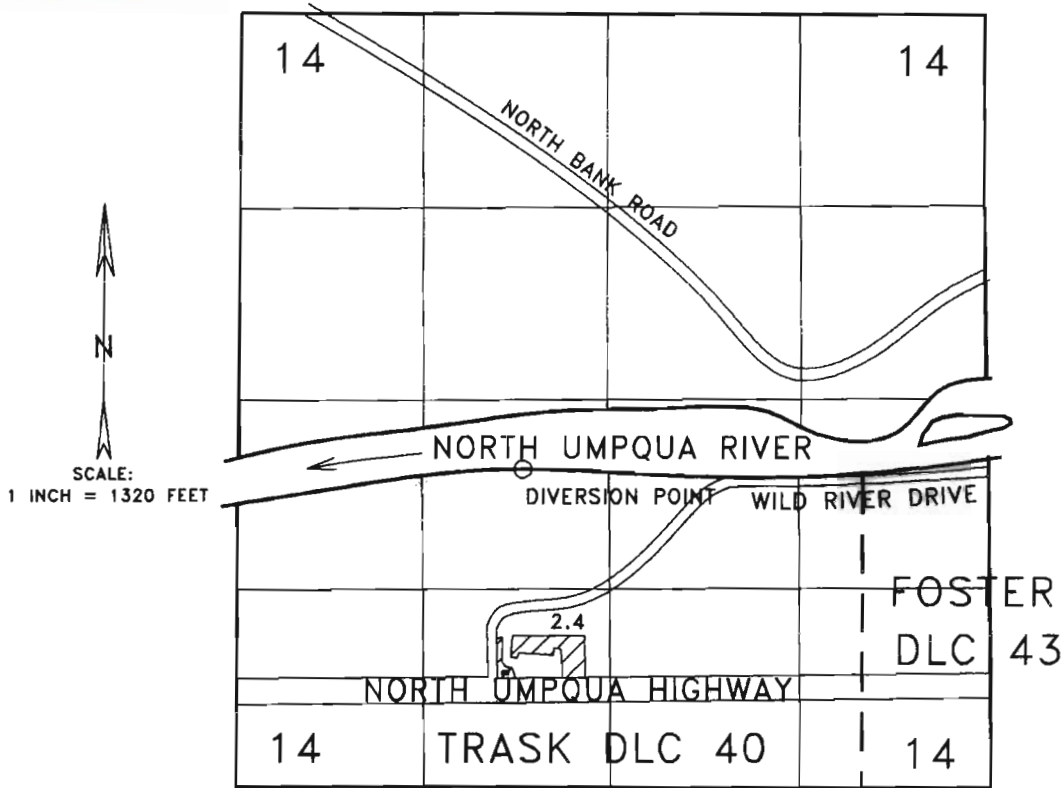

THE DIVERSION POINT IS LOCATED 2170 FEET NORTH AND 3160 FEET WEST FROM THE SOUTHEAST CORNER OF SECTION 14.

FINAL PROOF SURVEY
for
NORTH UMPQUA BIBLE FELLOWSHIP
TRANSFER 6279

THE PURPOSE OF THIS MAP IS TO IDENTIFY THE LOCATION OF THE WATER RIGHT. IT IS NOT INTENDED TO PROVIDE INFORMATION RELATIVE TO THE LOCATION OF PROPERTY OWNERSHIP BOUNDARY LINES.

