

RECEIVED

AUG 21 1992

WATER RESOURCES DEPT.
SALEM, OREGON.

T. 3 S. R. 4 W. W.M.
YAMHILL COUNTY

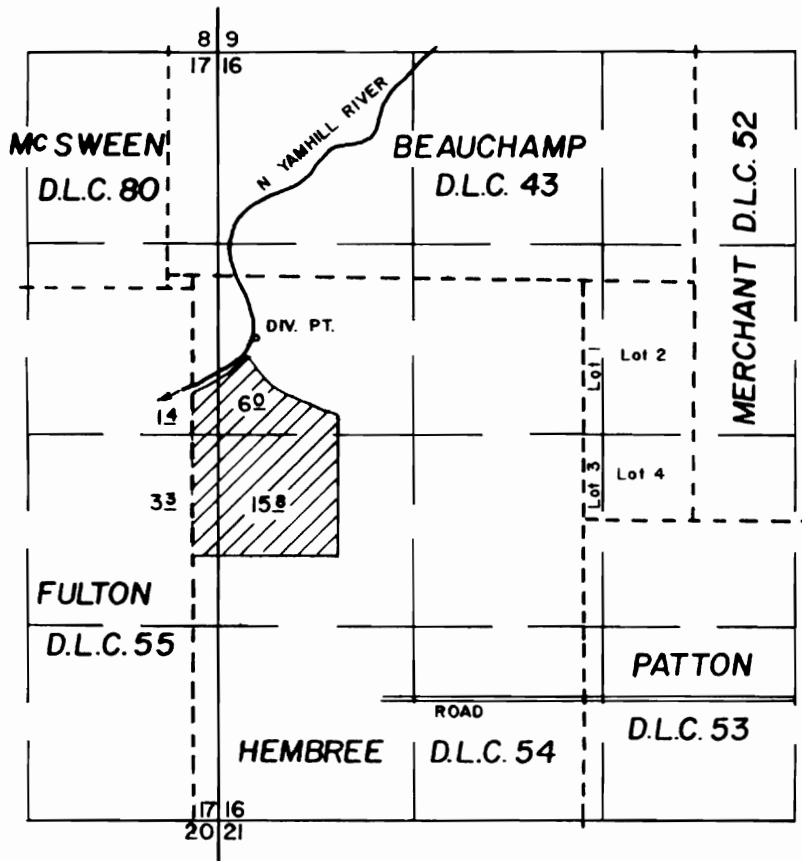

DIV. PT. LOCATION: 380' S & 2240' W OF NE. COR. D.L.C. 54

FINAL PROOF SURVEY

Application No 17660 Permit No 13354 Transfer No. T-6353

BAILEY NURSERIES INC.

JULY 24, 1992
SCALE 1" = 1320'



NOTE: This map is for the purpose of identifying the location of water rights and has no intent to dimension or locate property ownership lines.