

T.3S. R.4W. W.M.
YAMHILL COUNTY

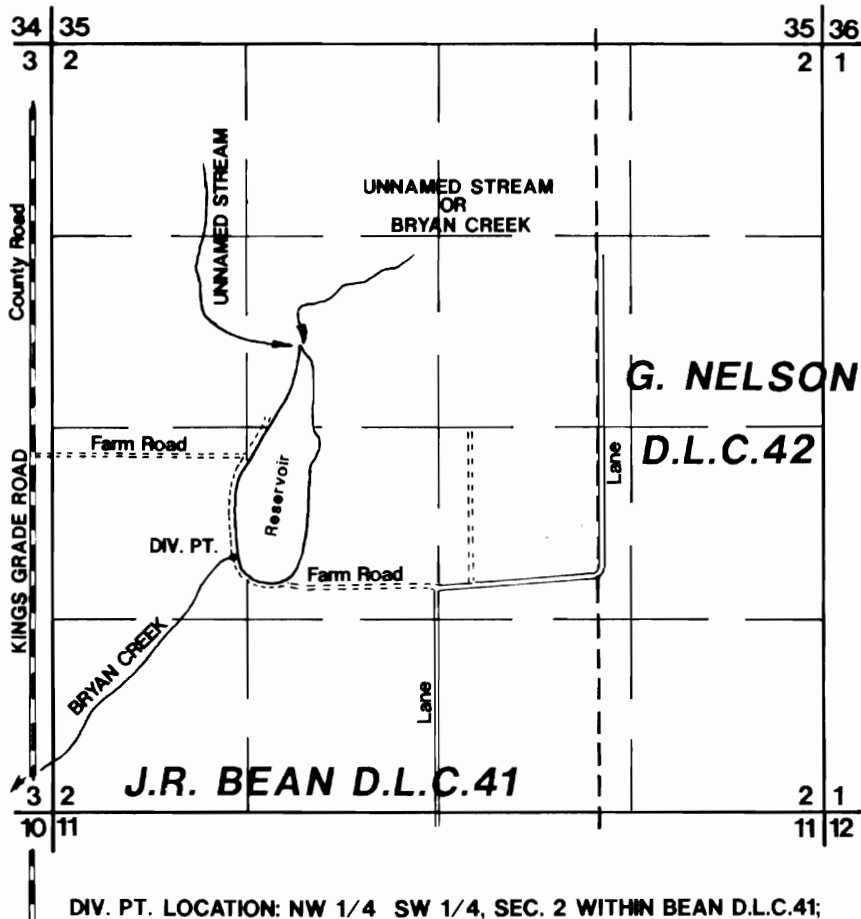

DIV. PT. LOCATION: NW 1/4 SW 1/4, SEC. 2 WITHIN BEAN D.L.C.41;
1750' N AND 1240' E OF SE COR. SEC. 2

FINAL PROOF MAP

Application No. R-25833 R-28748 R-29637 Permit No. R-1407 R-1560 R-1761 Transfer No. T-6354

BAILEY NURSERIES INC

APRIL 8, 1994
SCALE 1" = 1320'



NOTE: This map is for the purpose of identifying the location of water rights and has no intent to dimension or locate property ownership lines.