

T.2S. R.4W. W.M.

YAMHILL COUNTY

FILED
MAY 30 1989

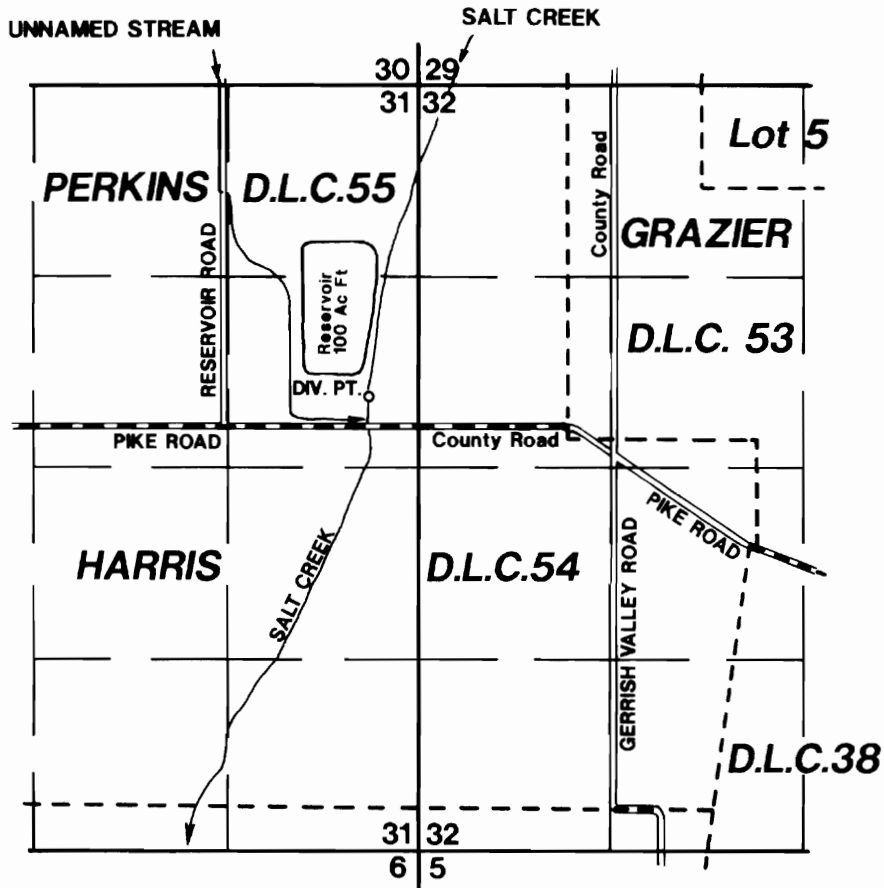

DIV. PT. LOCATION:
ON SALT CREEK 220' N AND 1380' W FROM SE COR. PERKINS D.L.C.55

FINAL PROOF MAP

Application No. R-45351 Permit No. R-5378 Transfer No. T-6355

BAILEY NURSERIES INC

APRIL 8, 1994
SCALE 1" = 1320'

NOTE: This map is for the purpose of identifying the location of water rights and has no intent to dimension or locate property ownership lines.

