

# T. 2N., R. 31E., W.M.

UMATILLA COUNTY

Well Loc. 200' North & 1950' East of West 1/4 of Section 16  
POD #1 - S 68°19" E 2011.8' from W 1/4 Corner of Section 16  
POD #2 - S 49°20" E 1145.0' from W 1/4 Corner of Section 16

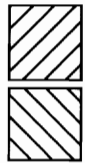

Permit# G-11435

Transfer #T-6368

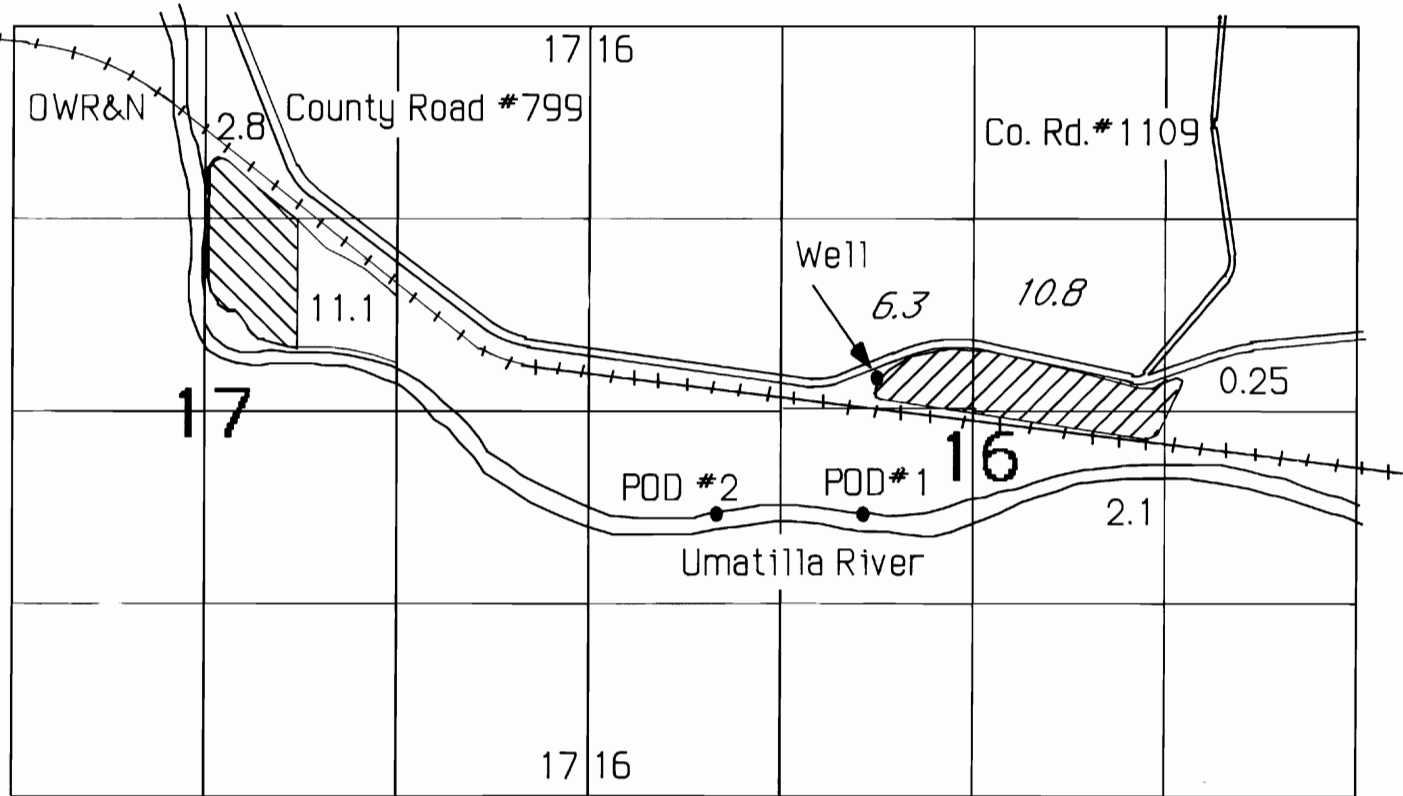

THIS MAP IS FOR THE PURPOSE OF IDENTIFYING THE LOCATION OF WATER RIGHTS ONLY AND IS NOT INTENDED TO PROVIDE THE LEGAL DIMENSIONS OR LOCATIONS OF PROPERTY OWNERSHIP LINES.

WATER RIGHTS PROOF MAP

IN NAME OF

Dean Forth

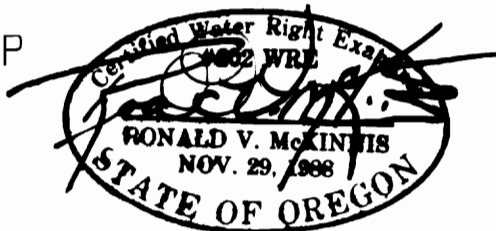

SCALE 1" = 1320'

ENGINEERING - SURVEYING - WATER RIGHTS

**R V MCKINNIS ENGINEERING**

Rt 1 Box 1122 Hermiston, Oregon 97838

503-567-2017