

T. 7 S., R. 38 E., W.M.

T. 7 S., R. 39 E., W.M.

RECEIVED

APR 24 1993

WATER RESOURCES DEPT  
SALEM, OREGON

# FINAL PROOF SURVEY

UNDER

TRANSFERS 6403 AND 6635

IN NAME OF

PETER W. SCHOENINGH JR.

SURVEYED APRIL 22, 1993

THE PURPOSE OF THIS MAP IS FOR IDENTIFYING  
THE LOCATION OF THE WATER RIGHT ONLY AND  
IS NOT INTENDED TO PROVIDE LEGAL DIMENSIONS  
OF PROPERTY OWNERSHIP LINES.

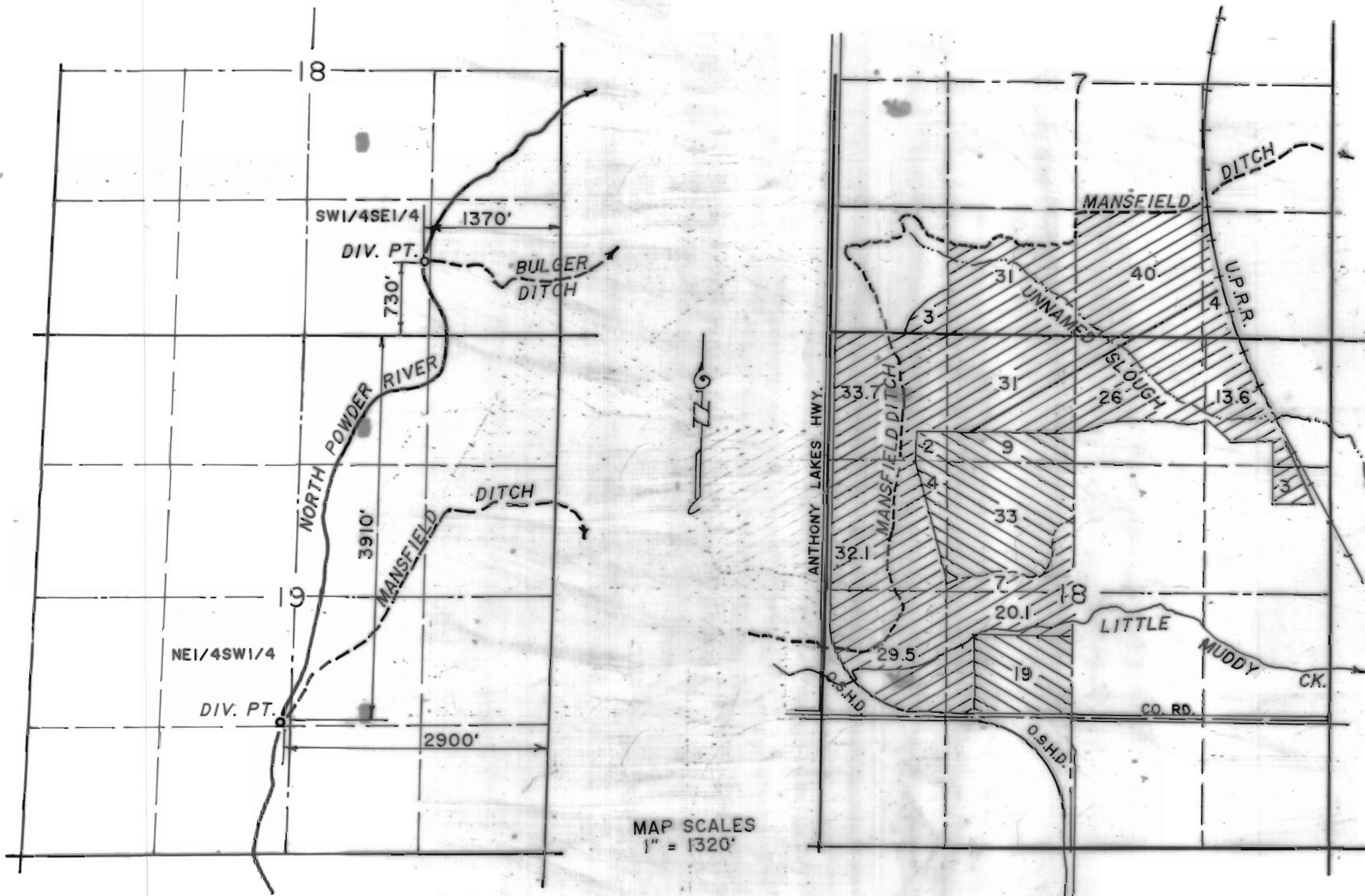

MAP SCALES  
1" = 1320'

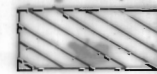

1887 PRIORITY

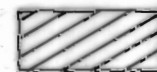

1890 PRIORITY

