

# T.10S., R.2W., W.M.

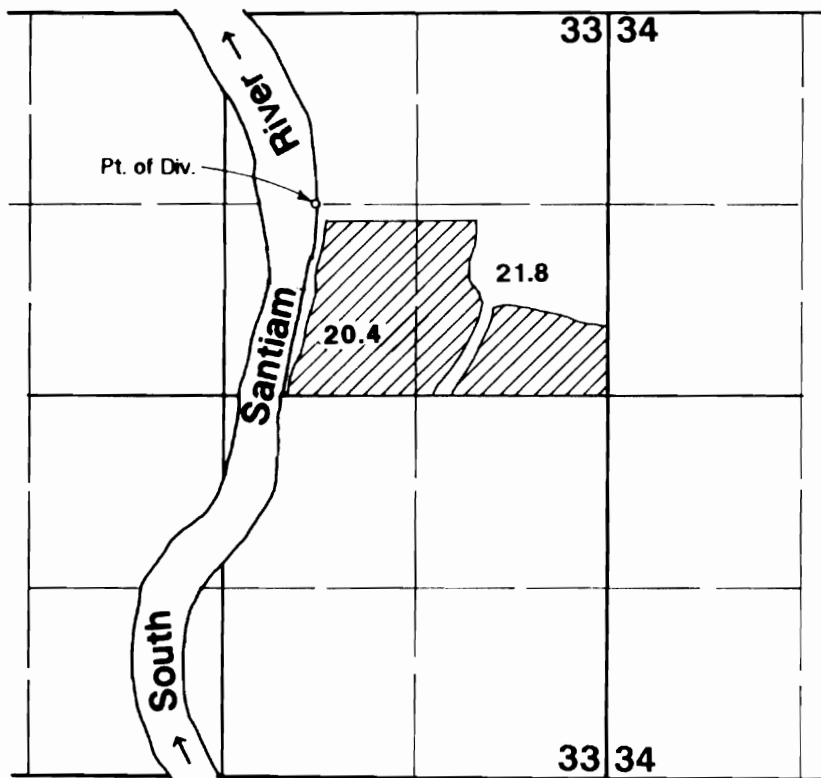

Area Irrigated

POD located 1310'S & 2000'W from NE corner Section 33.

## Final Proof Survey

Transfer #: T-6420

In Name Of

# Robert L. Stockhoff

Surveyed on September 3, 1993 by JM Schuette

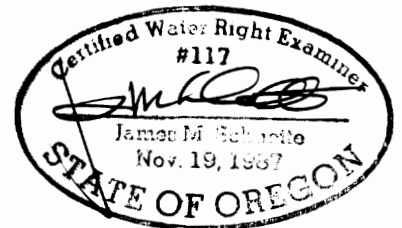

THIS MAP WAS PREPARED FOR THE PURPOSE OF IDENTIFYING THE LOCATION OF A WATER RIGHT ONLY AND IS NOT INTENDED TO PROVIDE LEGAL DIMENSIONS OR LOCATION OF PROPERTY OWNERSHIP LINES.