

FINAL PROOF SURVEY MAP FOR T-6433 MIKE AND JANE McCARTY T. 2N., R. 27E. WM.

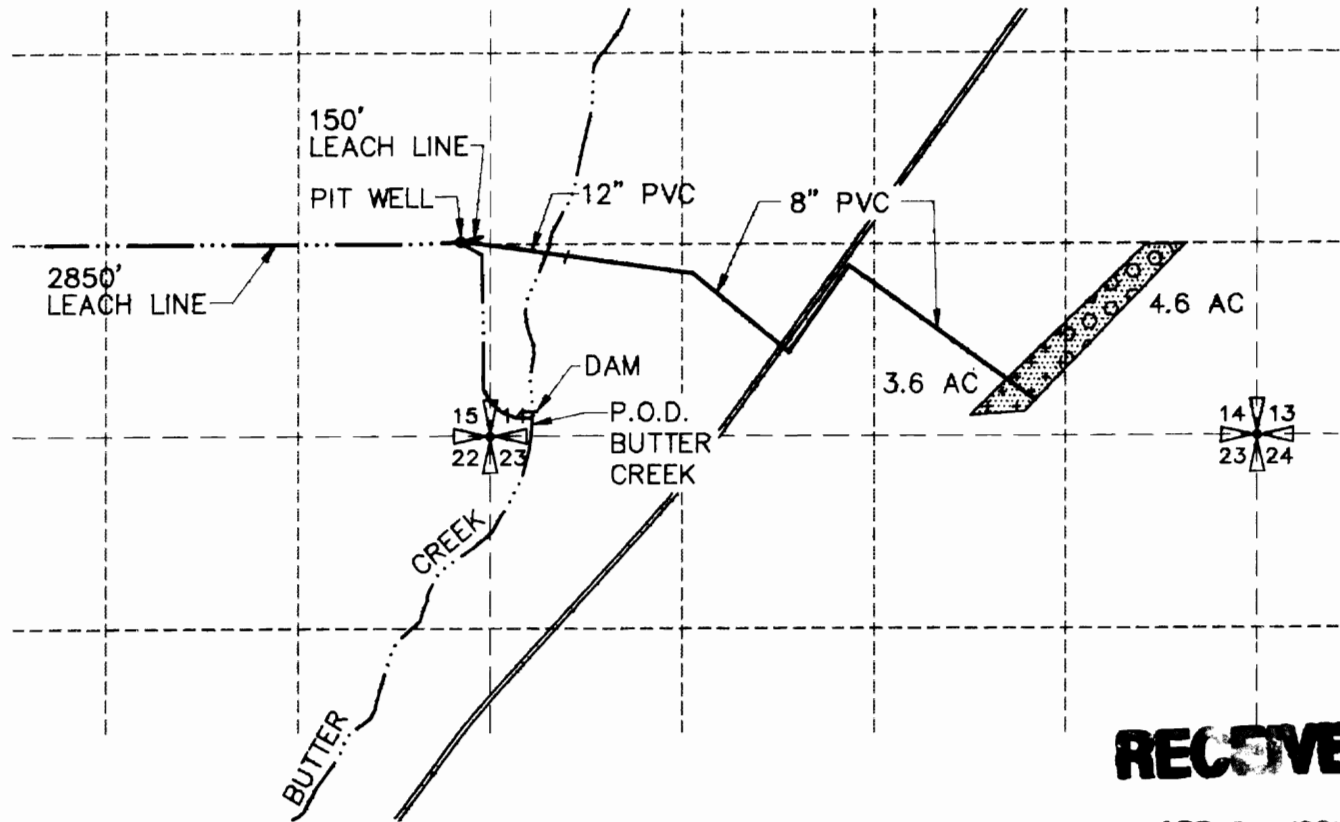

BUTTER CREEK
P.O.D. 124' NORTH AND 290' EAST
FROM THE SW CORNER SECTION 14

PIT WELL
P.O.D. 1380' NORTH AND 210' WEST
FROM THE SE CORNER SECTION 15

RECEIVED

APR 24 1996

WATER RESOURCES DEPT.
SALEM, OREGON

- PRIMARY CERTIFICATE 2653 1883
- PRIMARY PERMIT 26080 MARCH 23, 1959
- SUPPLEMENTAL PERMIT G-7145 NOVEMBER 15, 1976

Dale K. [unclear]

4/19/96