

T.4S., R.1W., W.M.

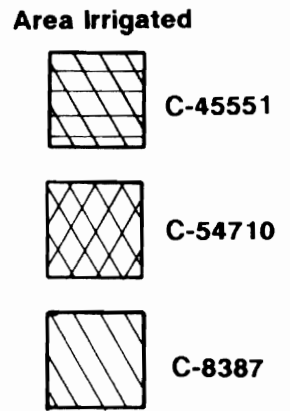
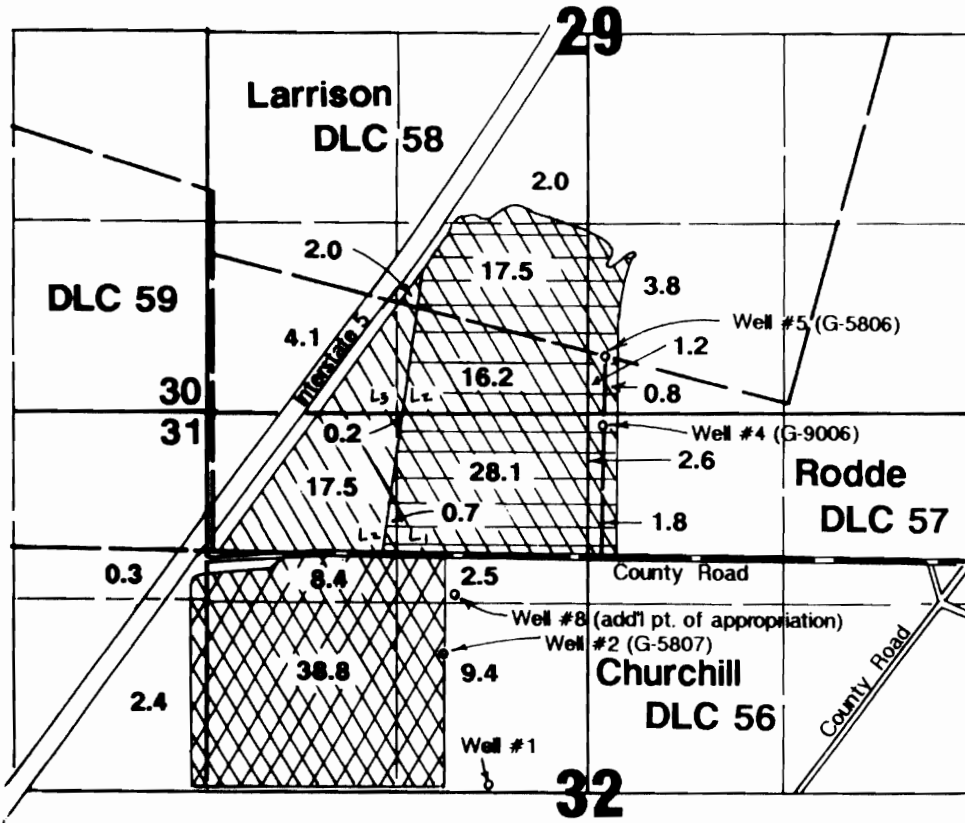

Well #8 (add'l pt. of appropriation) located 1380'N & 920'W from center Section 32.

Final Proof Survey

Transfer #6438

In Name Of

Tom DeArmond

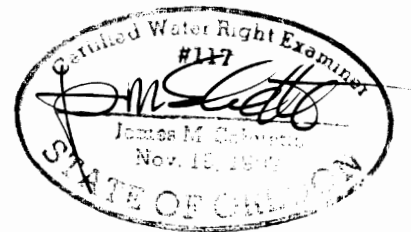

Surveyed on October 15, 1993 by JM Schuette

THIS MAP WAS PREPARED FOR THE PURPOSE OF IDENTIFYING THE LOCATION OF A WATER RIGHT ONLY AND IS NOT INTENDED TO PROVIDE LEGAL DIMENSIONS OR LOCATION OF PROPERTY OWNERSHIP LINES.