

RECEIVED

SEP 10 1998

WATER RESOURCES DEPT.
SALEM, OREGON

T. 7S. R. 1 W., W.M.

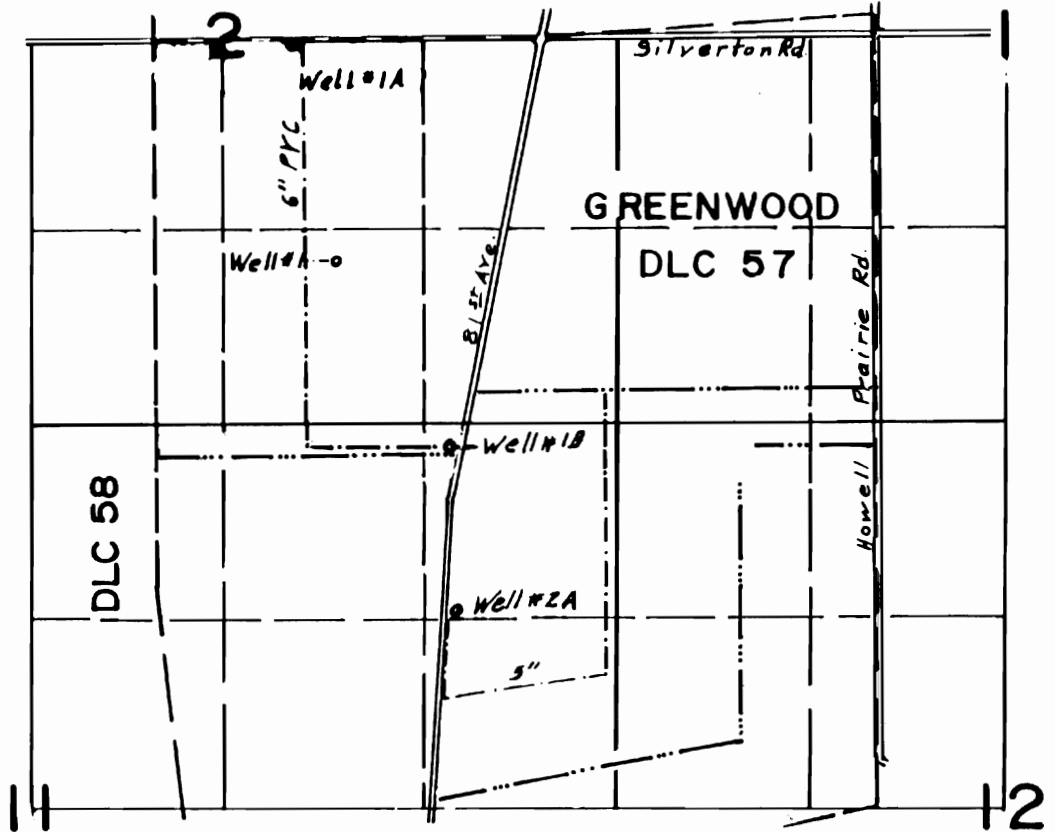
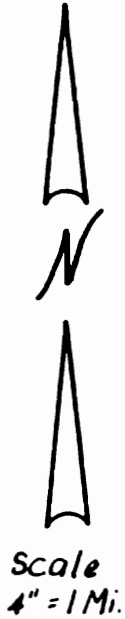

Well #1 1540'S & 1230'E From NW Cor. Greenwood DLC 57
Well #1A 40'S & 940'E " " " " " "
Well #1B 2785'S & 1980'E " " " " " "
Well #2A 1350'N & 2810'W " SE " " " "

**CORRECTION
FINAL PROOF SURVEY
UNDER**

TRANSFER NO. T-6448

Application No. Permit No.

IN NAME OF

G. & C. FARMS.....

Surveyed Aug. 29, 1998, by

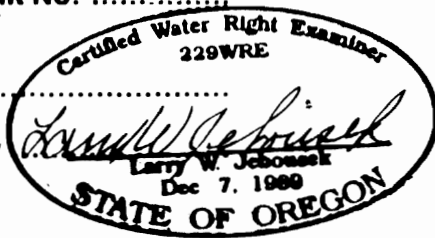

THIS MAP WAS PREPARED FOR THE PURPOSE OF IDENTIFYING THE LOCATION OF A WATER RIGHT ONLY AND IS NOT INTENDED TO PROVIDE LEGAL DIMENSIONS OR LOCATION OF PROPERTY OWNERSHIP LINES.