

MAP TO ACCOMPANY APPLICATION FOR TRANSFER OF WATER RIGHT

TRANSFER NO. T-6489

POINT OF DIVERSION TABLE

- #1 2250' SOUTH & 1420' WEST FROM
NE COR. SEC. 4
- #2 3475' SOUTH & 500' EAST FROM
NW COR. SEC. 3



SCALE 1" = 1320'

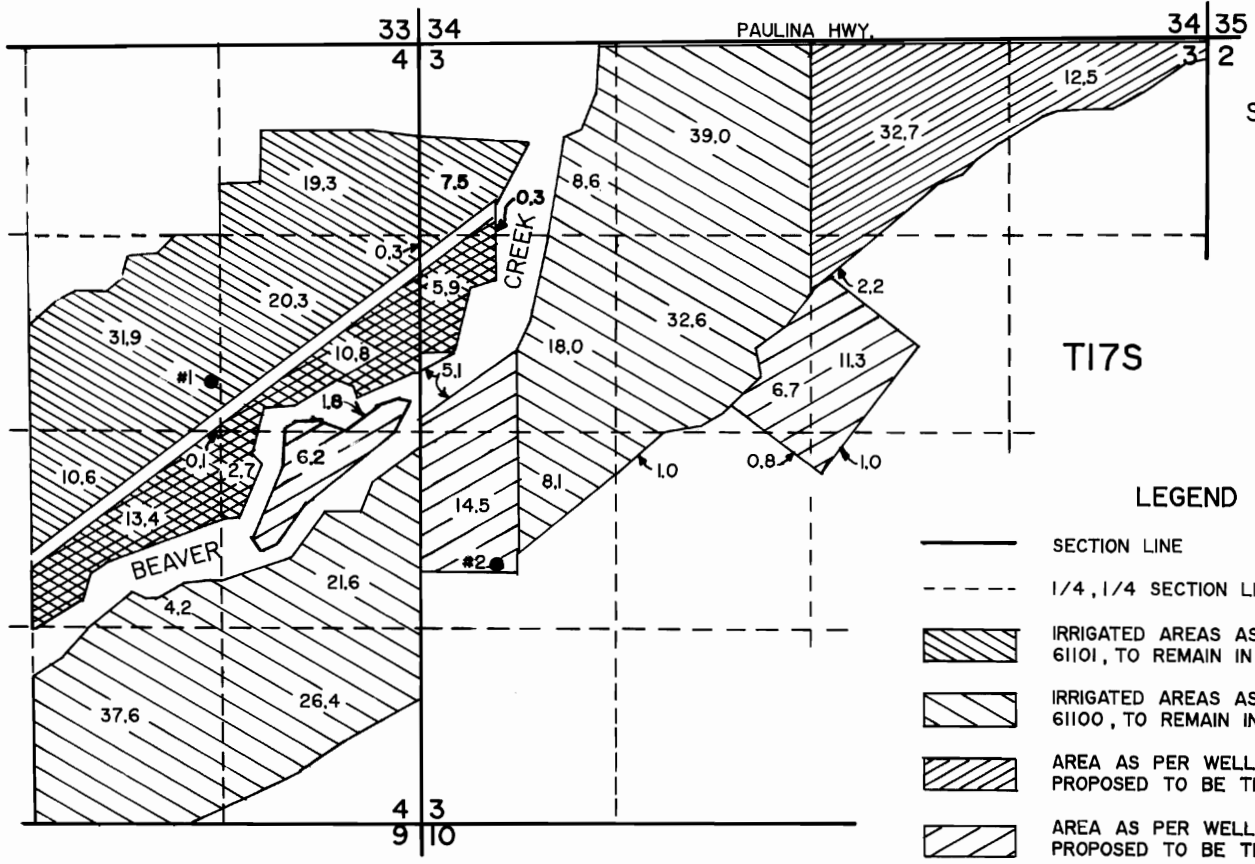

T17S

R23E

LEGEND

- SECTION LINE
- 1/4, 1/4 SECTION LINE
- IRRIGATED AREAS AS PER WELL 1, CERT. 61101, TO REMAIN IN PLACE
- IRRIGATED AREAS AS PER WELL 2, CERT. 61100, TO REMAIN IN PLACE
- AREA AS PER WELL 2, CERT. 61100, PROPOSED TO BE TRANSFERRED OUT
- AREA AS PER WELL 2, CERT. 61100 PROPOSED TO BE TRANSFERRED IN
- AREA UNDER CERT. 61101 PROPOSED TO CHANGE P.O.D. FROM WELL 1 TO WELL 2
- #1 ● WELL POINT OF DIVERSION AS NOTED IN TABLE



APPLICANT :

 PAULINA RANCH
 P.O. BOX 46
 PAULINA, OREGON 97751
 (503) 477-3111

PREPARED BY :

 ANDERSON ENGINEERING & SURVEYING
 344 SW 7TH STREET
 REDMOND, OREGON 97756
 (503) 923-4307
 FEB. 1991

NOTE: PREPARATION OF THIS MAP IS FOR IDENTIFYING PROPOSED WATER RIGHTS ONLY. IT HAS NO INTENT TO PROVIDE LOCATIONS OR DIMENSIONS OF PROPERTY BOUNDARIES.