

1994

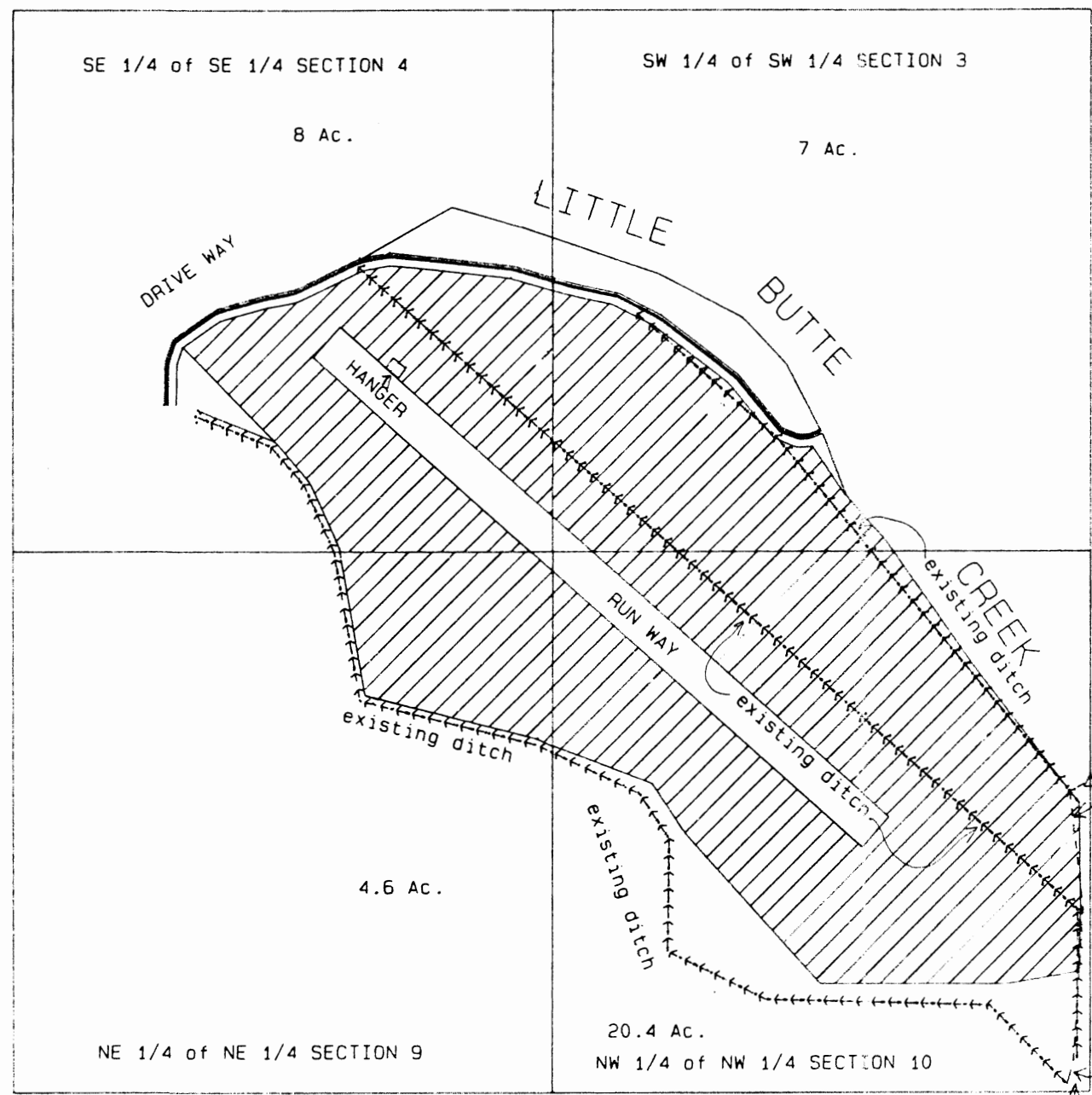

FINAL PROOF MAP

T. 36 S., R. 1 E., W.M.
TRANSFER No. 6548
WATER RIGHT CERTIFICATE No. 17201

JOHN RACHOR

9390 HIGHWAY 140
EAGLE POINT, OR. 97524

Prepared by:

Herbert A. Farber, CWRE
Farber & Sons, Inc.
908 E Jackson
Meford, Or. 97504
(503) 776-0846



Scale: 1" = 400'
Date: August 25, 1994

Cross hatched area is area
of beneficial use.

POINT OF DIVERSION
1320 FT EAST AND 560 FT SOUTH
NW SECTION 10

8 inch buried pipe

Small holding/transfer pond 5'x10'

NE 1/4 of NE 1/4 SECTION 9

NW 1/4 of NW 1/4 SECTION 10

Note: The preparation of this map was for the purpose of the proposed water right and has no intent to provide dimensions or locations of the property ownership lines.

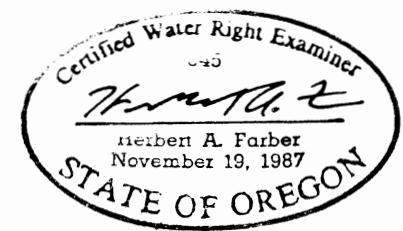

Expires 12/31/95