

RECEIVED

NOV 18 1983

WATER RESOURCES DEPT.
SALEM, OREGON

FINAL PROOF SURVEY
AND
CLAIM OF BENEFICIAL USE
NEW POINT OF APPROPRIATION
LOCATED IN
NE 1/4, SE 1/4, SECTION 16, T6N, R35E, W.M.
UMATILLA COUNTY, OREGON

WASHINGTON
OREGON

STATE
LINE

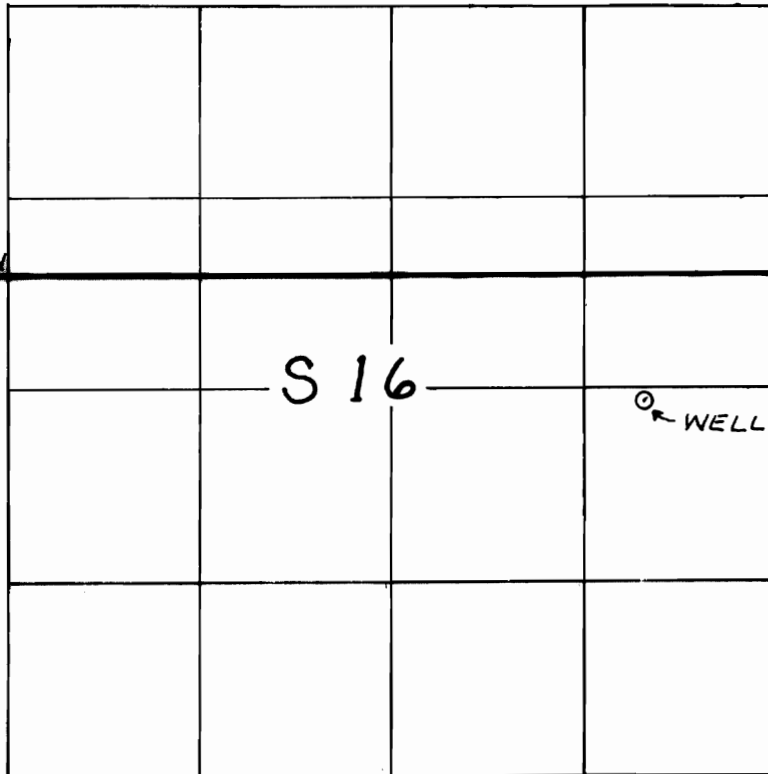

WELL

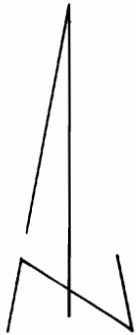

0 660 1320

SCALE - FEET

RUDOLPH G. RENCKEN, OWNER
TRANSFER No. 6557

NEW WELL IS LOCATED 2,545 FEET NORTH
AND 900 FEET WEST OF THE SOUTHEAST
CORNER OF SECTION 16, T6N, R35E, W.M.

THIS MAP IS PREPARED
FOR THE EXPRESS PURPOSE
TO SHOW WATER APPROPRIATION AND USE. IT IS
NOT INTENDED TO SHOW
PROPERTY OWNERSHIP LINES.

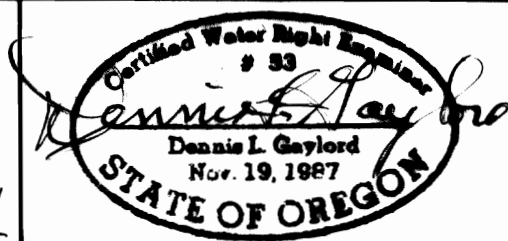

DENNIS L. GAYLORD, C.W.R.E.
4107 S.W. LAKE DRIVE
PENDLETON, OR 97801
503-276-6260