

3" BRASS CAP WIT- 7  
 NESS CORNERS 40 FT.  
 WEST AND 80 FT. SOUTH  
 OF TRUE COR. IN RIVER  
 SLOUGH  
NEW POINT OF  
 DIVERSION

NW 1/4 NW 1/4, SEC. 8,  
 T. 15 S., R. 16 E., W. M.;  
 LOCATED 320 FEET  
 EAST AND 150 FEET  
 SOUTH OF NW CORNER  
 SECTION 8.

T. 15 S., R. 16 E., W. M.

T-6569

PREVIOUS P.O.D.  
 SW 1/4 SE 1/4, SEC. 36, T15S.  
 R15E, W.M.; 60 FEET NORTH  
 AND 1940 FEET WEST FROM  
 SE CORNER SECTION 36.  
 T. 15 S., R. 15 E., W. M.

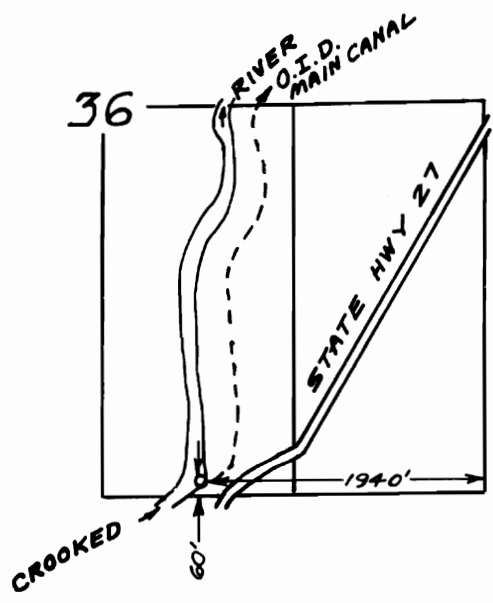

PREPARED FOR  
 CROOK COUNTY PARKS  
 & RECREATION DISTRICT  
 398 N. FAIRVIEW STREET  
 PRINEVILLE, OR 97754  
 [541] 447-1209



1998  
 JUNE 22 1998  
 WASHINGTON COUNTY  
 REC'D

SURVEY NOTE  
 THE PREPARATION OF THIS MAP  
 IS FOR THE PURPOSE OF IDENT-  
 IFYING THE LOCATION OF THE  
 WATER RIGHT ONLY AND HAS NO  
 INTENT TO PROVIDE DIMENSIONS  
 OR LOCATIONS OF PROPERTY  
 OWNERSHIP LINES.

LEGEND

- POINT OF DIVERSION
- ▨ PERMIT 25991  
 PRIORITY APRIL 8, 1914  
 CERT. NO. 57613

FINAL PROOF SURVEY

ARMSTRONG SURVEYING  
 & ENGINEERING, INC.  
 378 EAST SECOND ST.  
 PRINEVILLE, OREGON 97754  
 [541] 447-7791 FB. 148

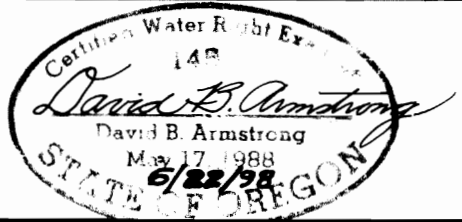

SCALE: 1" = 1320'

DATE: JUNE 17, 1998

W. O. 98-1648