

# T.4S., R.2W., W.M.

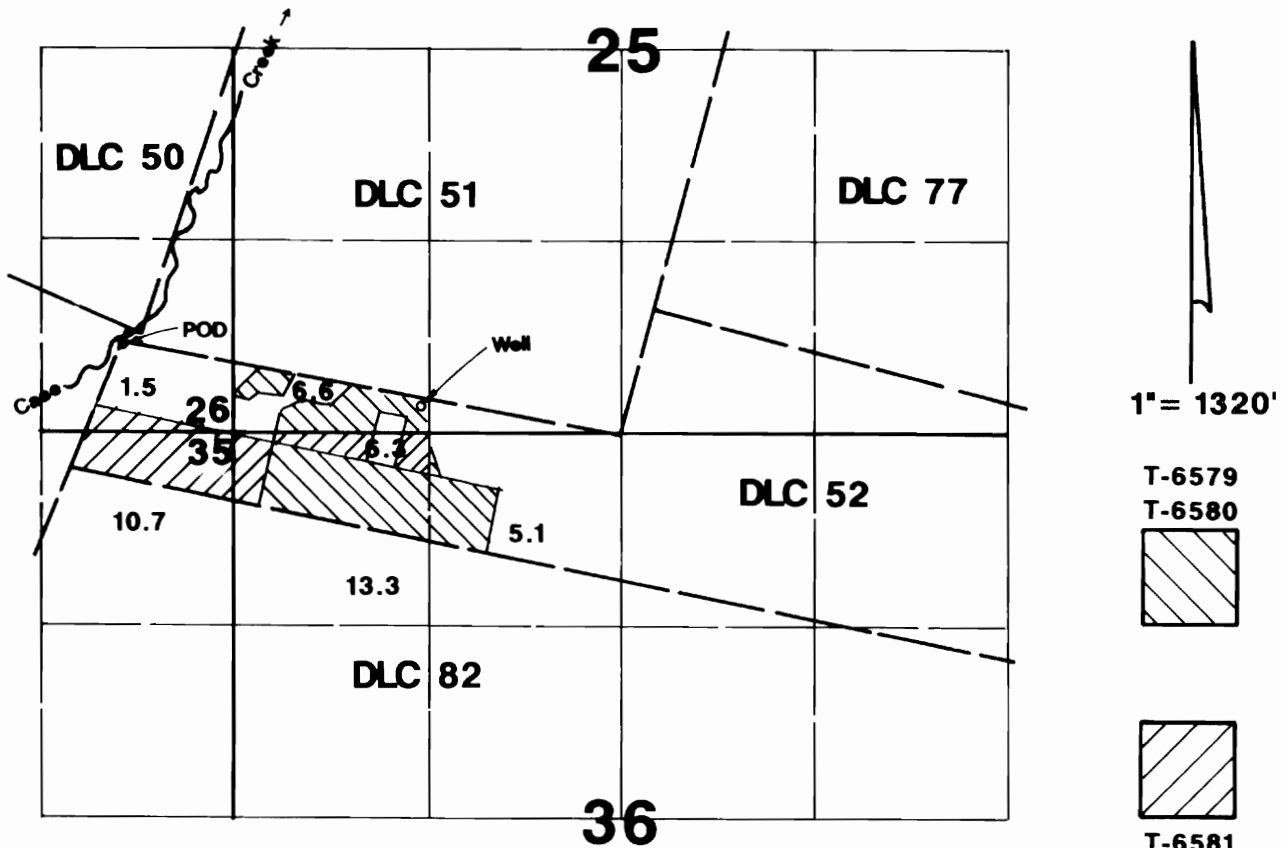

Well located 200'N & 1370'W from SE corner Jackson DLC 51.  
POD located 590'N & 3390'W from SE corner Jackson DLC 51.

## Final Proof Survey

Transfer #: T-6579 & 6580; T-6581 & 6582

In Name Of

### Rick J. Sonnen

Surveyed on September 5, 1993 by JM Schuette

THIS MAP WAS PREPARED FOR THE PURPOSE OF IDENTIFYING THE LOCATION OF A WATER RIGHT ONLY AND IS NOT INTENDED TO PROVIDE LEGAL DIMENSIONS OR LOCATION OF PROPERTY OWNERSHIP LINES.

