

RECEIVED

AUG 20 1997

WATER RESOURCES DEPT.  
SALEM, OREGON

# T.6S., R.2W., W.M.

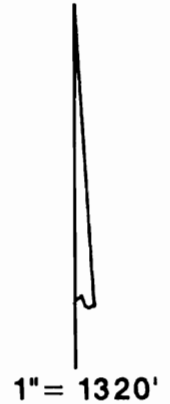
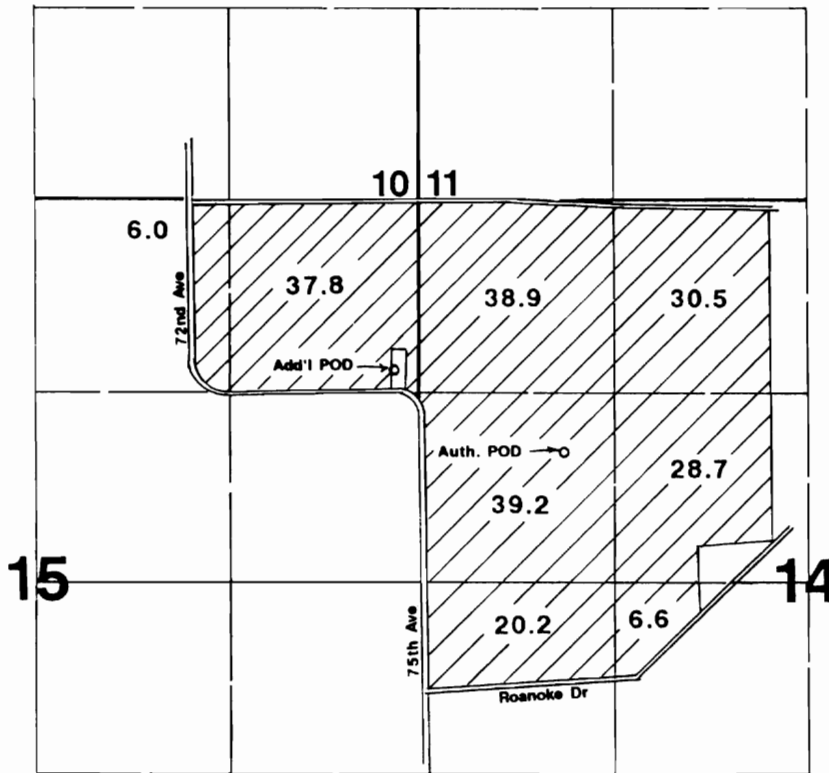

Auth. POD located 1750'S & 1000'E from NW corner Section 14.  
 Add'l POD located 1140'S & 150'W from NW corner Section 14.

## Final Proof Survey

Transfer #: T-6583

In Name Of

# James and/or Betty Hollin

Surveyed on July 25, 1997 by JM Schuette

THIS MAP WAS PREPARED FOR THE PURPOSE OF IDENTIFYING THE LOCATION OF A WATER RIGHT ONLY AND IS NOT INTENDED TO PROVIDE LEGAL DIMENSIONS OR LOCATION OF PROPERTY OWNERSHIP LINES.

