

# T.6S., R.2W., W.M.

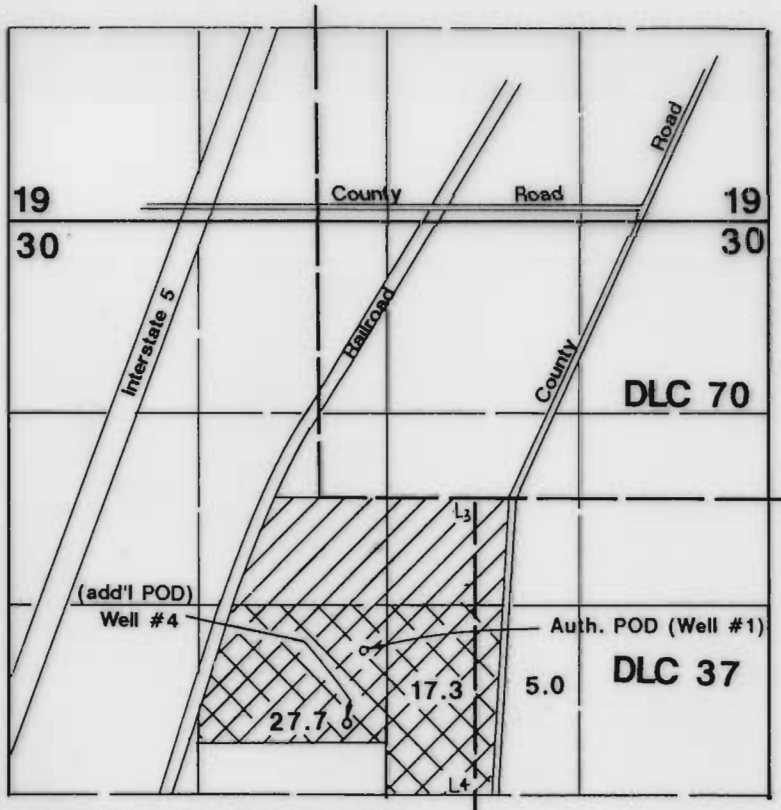

1" = 1320'

Area Irrigated



Add'l POD

Auth. POD located 1040'S & 310'E

Add'l POD located 1550'S & 200'E both from SW corner DLC 70.

## Final Proof Survey

Transfer #: T-7010

In Name Of

### Victor Petroff

(Trustee Madelon Petroff Living Trust)

Surveyed on September 12, 1996 by JM Schuette

RECEIVED

SEP 24 1996

WATER RESOURCES DEPT.  
SALEM, OREGON

THIS MAP WAS PREPARED FOR THE PURPOSE OF IDENTIFYING THE LOCATION OF A WATER RIGHT ONLY AND IS NOT INTENDED TO PROVIDE LEGAL DIMENSIONS OR LOCATION OF PROPERTY OWNERSHIP LINES.

