

001 0 4 1993

WATER RESOURCES DEPT
SALEM, OREGON

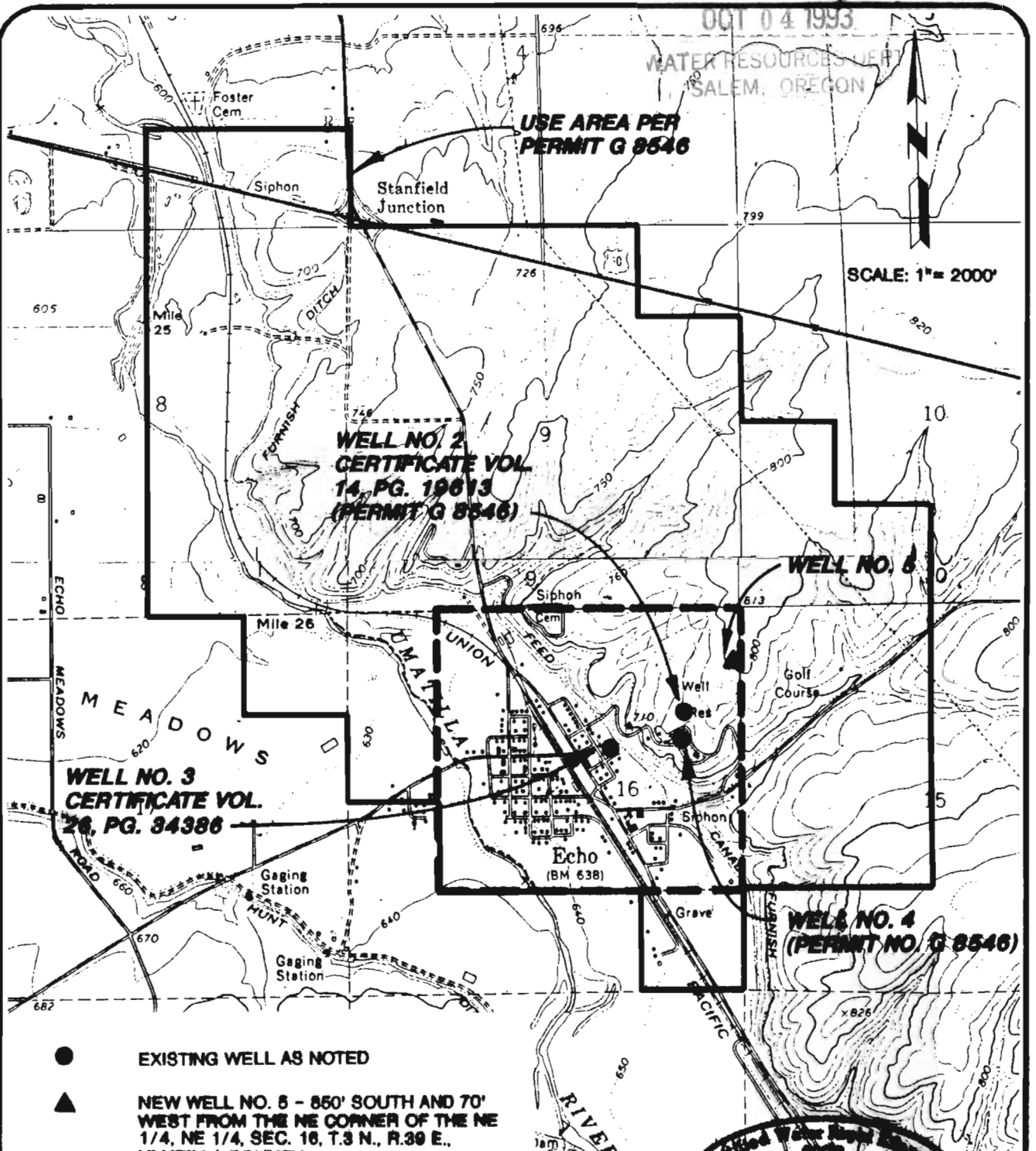

SCALE: 1" = 2000'



- EXISTING WELL AS NOTED
- ▲ NEW WELL NO. 5 - 850' SOUTH AND 70' WEST FROM THE NE CORNER OF THE NE 1/4, NE 1/4, SEC. 16, T.3 N., R.39 E., UMATILLA COUNTY

--- USAGE AREA PER CERTIFICATES VOL. 14, PAGE 19613, AND VOL. 26, PAGE 34386 (PERMITS U-168 AND G-64)

9-13-93



EXPIRES: 12-31-93



CITY OF
ECHO, OREGON
P.O. BOX 9 ECHO, OREGON 97826
APPLICATION MAP
TO ADD A POINT OF DIVERSION

FIGURE
1